



EN 60598-1	230V / 50Hz	IP 20	IK 02			960°C		RoHS	18W / 30W / 36W / 58W
------------	-------------	-------	-------	--	--	-------	--	------	-----------------------

**Domeniul de utilizare:** Iluminatul general de interior.

**Descriere:**

**Corp:** Armătură și șină din tablă de oțel vopsită cu pulbere

**Variantele** 118, 136, 158 pot fi echipate și cu întrerupător (i).

La cerere poate fi echipat cu balast electronic reglabil-HF-R, aparataj pentru iluminat de siguranță (cu excepția variantei de putere 118 și 218)

**Montaj:** Aparent

**Sursa:** Tub fluorescent (T8) și tuburi cu LED

**Dulie:** G13

**Standard:** SR EN 60598-1

**Application:** General indoor lighting.

**Description:**

**Body:** Steel sheet body and rail painted with powder

**Variants:** The 118, 136, 158 variants may be fitted with a switch (i).

On request may be fitted with electronic ballast dimmable-HF-R and emergency lighting kit (except for the 118 and 218 variants)

**Mounting:** Visible

**Source:** Tubular fluorescent lamp (T8) and tubular LED lamp

**Socket:** G13

**Standard:** SR EN 60598-1



FIA-11 cu întrerupător / with switch

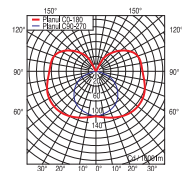

pg.285

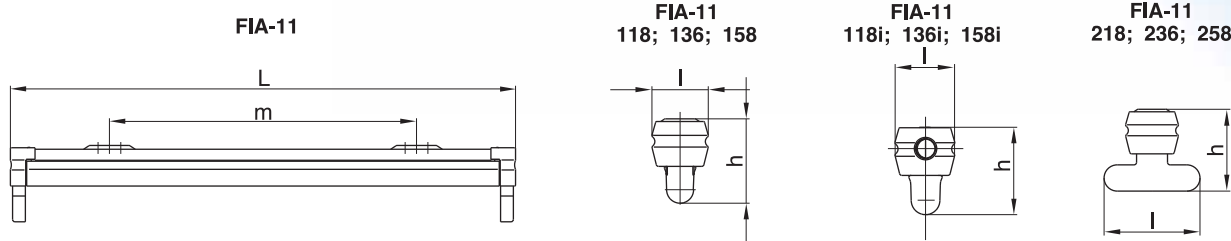

Tip/Type	Cod produs/ Product code	Factor de putere/ Power factor	Dimensiuni/Dimensions [mm]				Masa/ Weight [kg]	Lampa/ Lamp
			L	m	l	h		
1x18W	21131171	0.50	623	455	50.7	74	0.90	
1x18W HF-S	21131298	>0.96	623	455	50.7	74	0.70	
1x18W HF-P	21131227	>0.96	623	455	50.7	74	0.70	
1x30W	26371029	>0.92	925	600	50.7	74	1.25	
1x36W	21141176	>0.92	1227	900	50.7	74	1.45	
1x36W HF-S	21141215	>0.96	1227	900	50.7	74	1.00	
1x36W HF-P	21141316	>0.96	1227	900	50.7	74	1.00	
1x58W	21151171	0.50	1527.5	1100	40.6	60.8	2.00	
1x58W HF-S	21151227	>0.96	1527.5	1100	40.6	60.8	1.30	
1x58W HF-P	21151300	>0.96	1527.5	1100	40.6	60.8	1.30	
1x18W Î	21131223	0.50	623	455	50.7	74	0.90	
1x36W Î	21141223	>0.92	1227	900	50.7	74	1.45	
1x58W Î	21151223	>0.92	1527	1100	40.6	60.8	2.00	
2x18W	21132171	>0.92	617.5	455	102	80	1.30	
2x18W HF-S	21132196	>0.96	617.5	455	102	80	1.10	
2x18W HF-P	21132177	>0.96	617.5	455	102	80	1.10	
2x36W	21142176	>0.92	1227	900	102	80	2.50	
2x36W HF-S	21142215	>0.96	1227	900	102	80	1.50	
2x36W HF-P	21142244	>0.96	1227	900	102	80	1.50	
2x58W	21152171	>0.92	1527	1200	102	80	3.24	
2x58W HF-S	21152198	>0.96	1527	1200	102	80	1.65	
2x58W HF-P	21152227	>0.96	1527	1200	102	80	1.65	

\*Codurile pentru produse echipate cu tuburi LED se regăsesc la pg. 253 / The product code for equipping with LED tube to be found on pg. 253

EN 60598-1	230V / 50Hz	IP 20	IK 02			960°C		RoHS	28W / 35W / 80W
------------	-------------	-------	-------	--	--	-------	--	------	-----------------

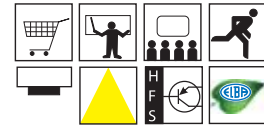

**Domeniu de utilizare:** Iluminat general de interior

**Descriere:**

**Corp:** Armătură și șina din tablă de oțel vopsită cu pulbere

**Reflector:** Oglindat (FIRA)

**Montaj:** Aparent

**Sursa:** Tub fluorescent (T5) și tuburi cu LED

**Dulie:** G5

**Standard:** SR EN 60598-1

**Application:** General indoor lighting

**Description:**

**Body:** Steel sheet body and rail painted with powder

**Reflector:** Mirrored reflector (FIRA)

**Mounting:** Visible

**Source:** Tubular fluorescent lamp (T5) and tubular LED lamp

**Socket:** G5

**Standard:** SR EN 60598-1

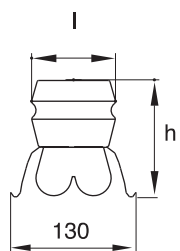
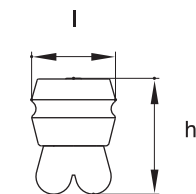
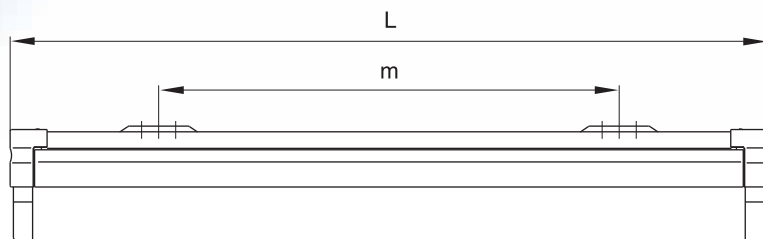

Reflector oglindat/  
Mirrored reflector

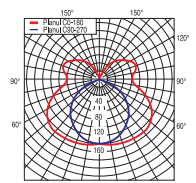

pg.285

Tip/Type	Cod produs/ Product code	Factor de putere/ Power factor	Dimensiuni/Dimensions [mm]				Masa/ Weight [kg]	Lampa/ Lamp
			L	m	l	h		
2x28W	21012002	>0.95	1176.5	900	50.7	70	1.05	T5 φ 16
2x35W	21022002	>0.95	1476.5	1200	50.7	70	1.15	
2x80W	21032002	>0.95	1476.5	1200	50.7	70	1.15	
2x28W cu/with reflector oglindat/mirrored	21012003	>0.95	1176.5	900	50.7	58	1.50	
2x35W cu/with reflector oglindat/mirrored	21022006	>0.95	1476.5	1200	50.7	85	1.75	
1x35W	21021006	>0.95	1476.5	1200	130	85	1.75	

\*Codurile pentru produse echipate cu tuburi LED se regăsesc la pg. 253 / The product code for equipping with LED tube to be found on pg. 253





EN 60598-1	230V / 50Hz	IP 40	IK 06			960°C		RoHS	18W / 36W / 58W
------------	-------------	-------	-------	--	--	-------	--	------	-----------------

**Domeniul de utilizare:** Iluminatul general de interior

**Descriere:**

**Corp:** Armătură și șină din tablă de oțel vopsită cu pulbere

**Dispersor:** Rotund, extrudat din PMMA transparent prevăzut cu o structură prismatică

**Variante:** Pot fi echipate și cu întrerupător (î).

La cerere poate fi echipat cu balast electronic reglabil-HF-R, aparataj pentru iluminat de siguranță (cu excepția variantei de putere 118).

**Montaj:** Aparent

**Sursa:** Tub fluorescent (T8) și tuburi cu LED

**Dulie:** G13

**Standard:** SR EN 60598-1

**Application:** General indoor lighting

**Description:**

**Body:** Steel sheet body and rail, painted with powder

**Diffuser:** Round, transparent extruded PMMA, with a prismatic structure

**Variants:** May be fitted with a switch (î).

On request may be fitted with electronic dimmable ballast HF-R and emergency lighting kit (except for the 118).

**Mounting:** Visible

**Source:** Tubular fluorescent lamp (T8) and tubular LED lamp

**Socket:** G13

**Standard:** SR EN 60598-1



FIA-11 Dr cu întrerupător/ with switch

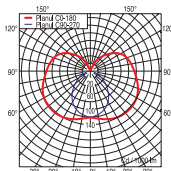

pg.285

FIA-11-118 Dr; 136 Dr; 158 Dr

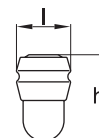
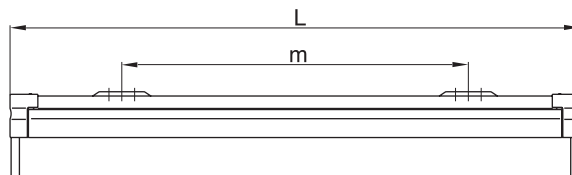

Tip/Type	Cod produs/ Product code	Factor de putere/ Power factor	Dimensiuni/Dimensions [mm]				Masa/ Weight [kg]	Lampa/ Lamp
			L	m	l	h		
1x18W Dr	21131180	0.50	617	455	50.7	85		
1x18W Dr HF-S	21131299	>0.96	617	455	50.7	85		
1x18W Dr HF-P	21131228	>0.96	617	455	50.7	85		
1x36W Dr	21141180	min. 0.92	1227	900	50.7	85		
1x36W Dr HF-S	21141230	>0.96	1227	900	50.7	85		
1x36W Dr HF-P	21141317	>0.96	1227	900	50.7	85		
1x58W Dr	21151180	min. 0.92	1527	1200	50.7	85		
1x58W Dr HF-S	21151229	>0.96	1527	1200	50.7	85		
1x58W Dr HF-P	21151301	>0.96	1527	1200	50.7	85		
1x18W î, Dr	21131222	0.50	617	455	50.7	85		
1x36W î, Dr	21141222	min. 0.92	1227	900	50.7	85		
1x58W î, Dr	21151222	min. 0.92	1527	1200	50.7	85		

\*Codurile pentru produse echipate cu tuburi LED se regăsesc la pg. 253 / The product code for equipping with LED tube to be found on pg. 253



EN 60598-1	230V / 50Hz	IP 20	IK 02			960°C	CE	RoHS	28W
------------	-------------	-------	-------	--	--	-------	----	------	-----



**FIA-12**  
128; 228

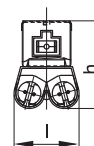
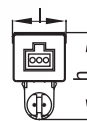
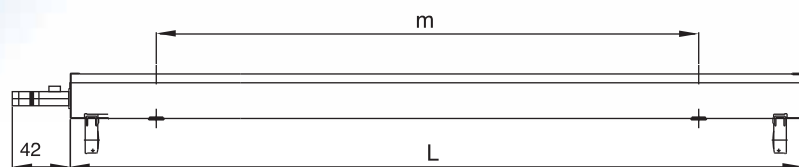

**FIA-12 cu  
conector/  
with connector**

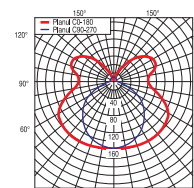

pg.286

Tip/Type	Cod produs/ Product code	Factor de putere/ Power factor	Dimensiuni/Dimensions [mm]				Masa/ Weight [kg]	Lampa/ Lamp
			L	m	l	h		
1x28W	21011001	>0.95	1187	900	35	57	1.10	T5  φ 16
2x28W	21012001	>0.95	1187	900	46	62	1.35	





EN 60598-1	230V / 50Hz	IP 20	IK 02	⊕	▽	960°C	CE	RoHS	18W / 36W / 58W
------------	-------------	-------	-------	---	---	-------	----	------	-----------------

**Domeniul de utilizare:** Iluminatul general de interior

**Descriere:**

**Corp:** Armătură și sină din tablă de oțel vopsită cu pulbere

**Reflector:** Tablă de oțel vopsită cu pulbere

La cerere poate fi echipat cu: balast electronic reglabil-HF-R și aparataj pentru iluminat de siguranță; grătar; reflector oglindat

**Montaj:** Aparent

**Sursa:** Tub fluorescent (T8) și tuburi cu LED

**Dulie:** G13

**Standard:** SR EN 60598-1

**Application:** General indoor lighting

**Description:**

**Body:** Steel sheet body and rail, painted with powder

**Reflector:** Steel sheet reflector painted with powder

On request may be fitted with: electronic dimmable ballast HF-R and emergency lighting kit; grid; mirrored reflector

**Mounting:** Visible

**Source:** Tubular fluorescent lamp (T8) and tubular LED lamp

**Socket:** G13

**Standard:** SR EN 60598-1



FIRA-11 cu grătar / with grid



FIRA-11 cu reflector oglindat / with mirrored reflector

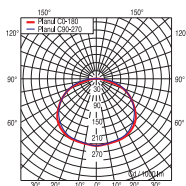

pg.286

FIRA-11-136; 158; 236; 258

136; 158

236; 258

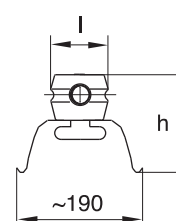
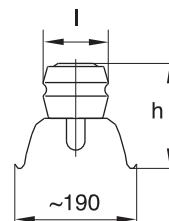
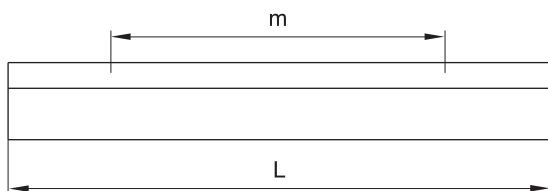

Tip/Type	Cod produs/ Product code	Factor de putere/ Power factor	Dimensiuni/Dimensions [mm]				Masa/ Weight [kg]	Lampa/ Lamp
			L	m	l	h		
1x36W	21141194	min. 0.92	1227	50.7	110	900	2.65	
1x36W HF-S	21141217	>0.96	1227	50.7	110	900	2.45	
1x36W HF-P	21141318	>0.96	1227	50.7	110	900	2.45	
1x58W	21151191	min. 0.92	1527.5	50.7	110	1200	3.85	
1x58W HF-S	21151228	>0.96	1527.5	50.7	110	1200	3.15	
1x58W HF-P	21151303	>0.96	1527.5	50.7	110	1200	3.15	
2x18W	21132191	min. 0.92	617	50.7	110	455	1.70	
2x36W	21142190	min. 0.92	1227	50.7	110	900	3.30	
2x36W HF-S	21142217	>0.96	1227	50.7	110	900	2.60	
2x36W HF-P	21142245	>0.96	1227	50.7	110	900	2.60	
2x58W	21152191	min. 0.92	1527.5	50.7	110	1200	4.10	
2x58W HF-S	21152199	>0.96	1527.5	50.7	110	1200	3.50	
2x58W HF-P	21152215	>0.96	1527.5	50.7	110	1200	3.50	

\*Codurile pentru produse echipate cu tuburi LED se regăsesc la pg. 253 / The product code for equipping with LED tube to be found on pg. 253





EN 60598-1	230V / 50Hz	IP 20	IK 02			960°C		RoHS	36W / 38W / 58W
------------	-------------	-------	-------	--	--	-------	--	------	-----------------

**Domeniul de utilizare:** Iluminatul general de interior

**Descriere:**

**Corp:** Armătură și sină din tablă de oțel vopsită cu pulbere

**Reflector asimetric (AS):** Tablă de oțel vopsită cu pulbere FIRA 11; Tablă de aluminiu oglindată cu coeficient de reflexie > 0,85-FIRA-02; FIRA-03

**Avantaje:** Flux luminos dirijat cu reflectorul asimetric

La cerere poate fi echipat cu balast electronic, aparataj pentru iluminat de siguranță, bloc de conectare "PUSH-IN", (FIRA 02 AS, FIRA 03 AS, FIRA 11 AS); conector rapid WIELAND și reflector oglindat (FIRA 11 AS)

**Montaj:** Aparent

**Sursa:** Tub fluorescent (T8)

**Dulie:** G13

**Standard:** SR EN 60598-1

**Application:** General indoor lighting

**Description:**

**Body:** Steel sheet body and rail, painted with powder

**Asymmetric reflector (AS):** Steel sheet reflector painted with powder - FIRA-11; mirrored aluminium sheet reflector with a reflection factor > 0.85 - FIRA-02; FIRA-03

**Advantages:** Luminous flux directed with the help of an asymmetric reflector

On request may be fitted with electronic ballast, emergency lighting kit, block connector "PUSH-IN" (FIRA 02 AS, FIRA 03 AS, FIRA 11 AS); WIELAND connector and mirrored reflector (FIRA 11 AS)

**Mounting:** Visible

**Source:** Tubular fluorescent lamp (T8)

**Socket:** G13

**Standard:** SR EN 60598-1



Reflector oglindat FIRA-11 AS/ mirrored reflector



conector WIELAND/ connector



conector PUSH-IN/ connector

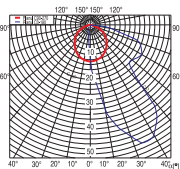

pg.287

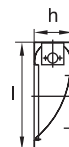
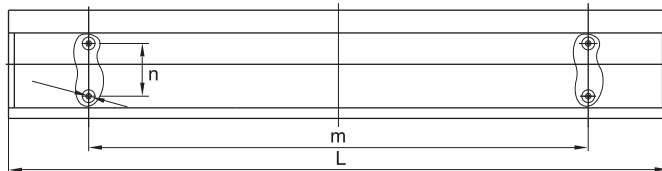

FIRA 02 AS -136; 138

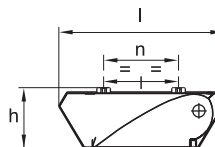
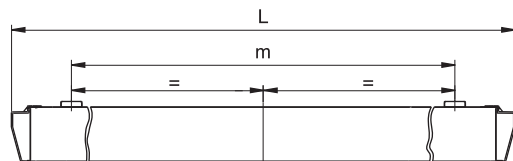

FIRA 03 AS -136

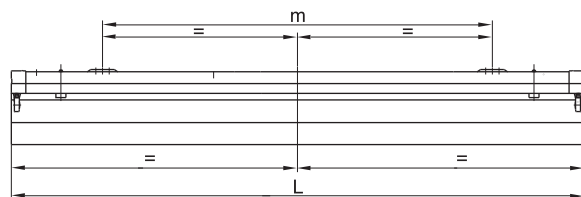

FIRA 11 AS -136; 158

Tip/Type	Cod produs/ Product code	Factor de putere/ Power factor	Dimensiuni/Dimensions [mm]				Masa/ Weight [kg]	Lampa/ Lamp
			L	m	l	h		
FIRA 02 AS 1x38W	21341158	min. 0.92	1188	195	70	900	3.40	T8 $\phi 26$
FIRA 03 AS 1x36W	21341155	min. 0.92	1276	242	88	900	3.25	
FIRA 11 AS 1x36W	21141226	min. 0.92	1228	78	135	900	2.65	
FIRA 11 AS 1x58W	21151226	min. 0.92	1528	78	135	1200	3.85	



EN 60598-1 230V / 50Hz IP 40 IK 07 960°C CE RoHS 18W / 55W



**Domeniul de utilizare:** Iluminatul general de interior

**Descriere:**

**Corp:** Armătură din tablă de oțel vopsită cu pulbere

**Reflector:** Tablă de aluminiu oglindată cu coeficient de reflexie > 0,85 în variantele simplu parabolic (SP), dublu parabolic (DP)

**Aparataj:** Varianta de 2x55 LC este cu balast electronic

La cerere poate fi echipat cu balast electronic.

**Montaj:** Aparent

**Sursa:** Lampă compactă (LC) TC-L

**Dulie:** 2G11

**Standard:** SR EN 60598-1

**Application:** General indoor lighting

**Description:**

**Body:** Steel sheet body, painted with powder

**Reflector:** Mirrored aluminum sheet reflector with a reflection factor > 0,85 in simple parabolic (SP) or double parabolic (DP) variants

**Gear:** 2x55 LC variant is equipped with electronic ballast

On request may be fitted with electronic ballast.

**Mounting:** Visible

**Source:** Compact lamp (LC) TC-L

**Socket:** 2G11

**Standard:** SR EN 60598-1



DP

SP

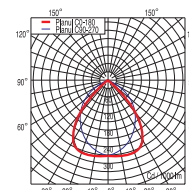
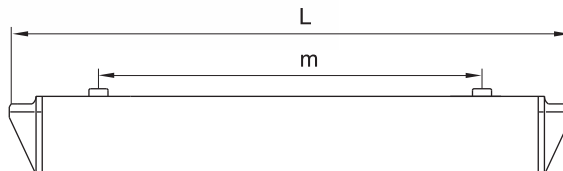
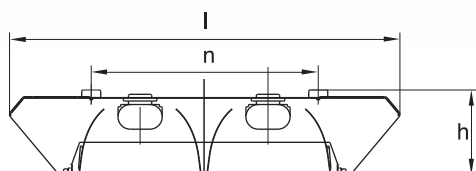

pg.287

Tip/Type	Cod produs/ Product code	Factor de putere/ Power factor	Dimensiuni/Dimensions [mm]					Masa/ Weight [kg]	Lampa/ Lamp
			L	m	l	h	n		
2x18W DP	21372011	min. 0.95	450	89	406	250	274	2.50	 TC-L
2x18W SP	21372013	min. 0.95	450	89	406	250	274	2.50	
2x55W SP HF-P	21372001	min. 0.95	697	89	406	250	360	3.65	







EN 60598-1	230V / 50Hz	IP 40	IK 07			960°C		RoHS	18W / 36W / 58W
------------	-------------	-------	-------	--	--	-------	--	------	-----------------

**Domeniul de utilizare:** Iluminatul general de interior

**Descriere:**

**Corp:** Armătură din tablă de oțel vopsită cu pulbere

**Reflector:** Tablă de aluminiu oglindată, cu coeficient de reflexie > 0.85, în variantele:

- dublu parabolic (DP): varianta de bază la 18w-7 lamele, 36w-16 lamele;
- simplu parabolic (SP): varianta de bază la 18w-9 lamele, 36w-20 lamele;
- drept (DR): varianta de bază la 18w-7 lamele

La cerere poate fi echipat cu balast electronic reglabil-HF-R (cu excepția variantelor 118, 218), aparataj pentru iluminat de siguranță, suspensii și bloc de conectare "PUSH-IN"

**Montaj:** Aparent/suspendat

**Sursa:** Tub fluorescent (T8) și tuburi cu LED

**Dulie:** G13

**Standard:** SR EN 60598-1

**Application:** General indoor lighting

**Description:**

**Body:** Steel sheet body, painted with powder

**Reflector:** Mirrored aluminum sheet reflector with a reflection factor > 0.85 in the following variants:  
 - double parabolic (DP): main variant for 18w-7 lamellas, 36w-16 lamellas;  
 - single parabolic (SP): main variant for 18w-9 lamellas, 36w-20 lamellas;  
 - flat (DR): main variant for 18w-7 lamellas

On request may be fitted with dimmable electronic ballast HF-R (except for the 118, 218 variants), emergency lighting kit, suspension cables and block connector "PUSH-IN"

**Mounting:** Visible/suspended

**Source:** Tubular fluorescent lamp (T8) and tubular LED lamp

**Socket:** G13

**Standard:** SR EN 60598-1



FIRA-03 suspensii/ suspension cables



conector PUSH-IN/ connector



DP



SP



DR

FIRA-03-118; 136; 158

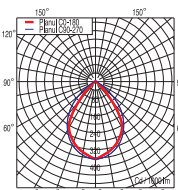
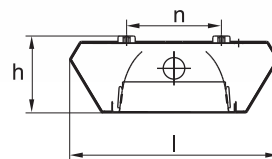

pg.288

FIRA-03-218; 236; 258

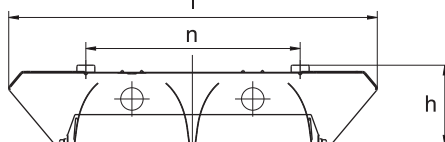

FIRA-03-118; 136; 158; 218; 236; 258

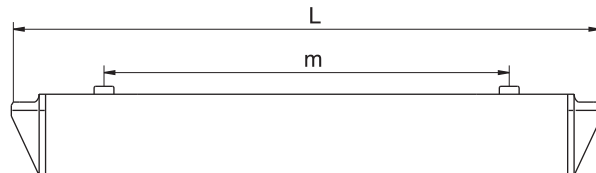

FIRA-03-418; 436; 458

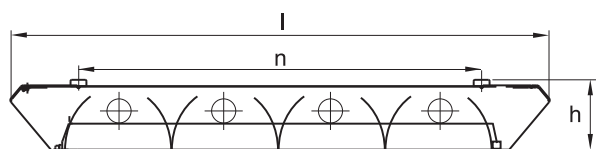

FIRA-03-418; 436; 458

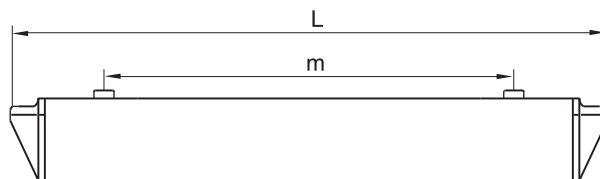

Tip/Type	Cod produs/ Product code	Factor de putere/ Power factor	Dimensiuni/Dimensions [mm]					Masa/ Weight [kg]	Lampa/ Lamp
			L	m	l	h	n		
1x18W SP	21331148	min. 0.92	665.5	450	242	89	110	2.00	
1x18W SP HF-S	21331160	>0.96	665.5	450	242	89	110	1.80	
1x18W SP HF-P	21331156	>0.96	665.5	450	242	89	110	1.80	
1x18W DP	21331146	min. 0.92	665.5	450	242	89	110	2.00	
1x18W DP HF-S	21331159	>0.96	665.5	450	242	89	110	1.80	
1x18W DP HF-P	21331152	>0.96	665.5	450	242	89	110	1.80	
1x36W SP	21341148	min. 0.92	1276	900	242	89	110	3.00	
1x36W SP HF-S	21341150	>0.96	1276	900	242	89	110	2.75	
1x36W SP HF-P	21341165	>0.96	1276	900	242	89	110	2.75	
1x36W DP	21341146	min. 0.92	1276	900	242	89	110	3.00	
1x36W DP HF-S	21341152	>0.96	1276	900	242	89	110	2.75	
1x36W DP HF-P	21341166	>0.96	1276	900	242	89	110	2.75	
1x58W SP	21351148	min. 0.92	1578	1202	242	89	110	4.46	
1x58W SP HF-S	21351150	>0.96	1578	1202	242	89	110	3.76	
1x58W SP HF-P	21351158	>0.96	1578	1202	242	89	110	3.76	
1x58W DP	21351146	min. 0.92	1578	1202	242	89	110	4.46	
1x58W DP HF-S	21351152	>0.96	1578	1202	242	89	110	3.76	
1x58W DP HF-P	21351157	>0.96	1578	1202	242	89	110	3.76	
2x18W SP	21332057	min. 0.92	697	360	406	89	250	2.80	
2x18W SP HF-S	21332152	>0.96	697	360	406	89	250	2.60	
2x18W SP HF-P	21332083	>0.96	697	360	406	89	250	2.60	
2x18W DP	21332059	min. 0.92	697	360	406	89	250	2.80	
2x18W DP HF-S	21332151	>0.96	697	360	406	89	250	2.60	
2x18W DP HF-P	21332081	>0.96	697	360	406	89	250	2.60	
2x36W SP	21342116	min. 0.92	1306	950	406	89	250	5.40	
2x36W SP HF-S	21342135	>0.96	1306	950	406	89	250	4.70	
2x36W SP HF-P	21342015	>0.96	1306	950	406	89	250	4.70	
2x36W DP	21342118	min. 0.92	1306	950	406	89	250	5.40	
2x36W DP HF-S	21342133	>0.96	1306	950	406	89	250	4.70	
2x36W DP HF-P	21342016	>0.96	1306	950	406	89	250	4.70	
2x58W SP	21352025	min. 0.92	1610	1200	406	89	250	8.20	
2x58W SP HF-S	21352034	>0.96	1610	1200	406	89	250	6.55	
2x58W SP HF-P	21352115	>0.96	1610	1200	406	89	250	6.55	
2x58W DP	21352021	min. 0.92	1610	1200	406	89	250	8.20	
2x58W DP HF-S	21352032	>0.96	1610	1200	406	89	250	6.55	
2x58W DP HF-P	21352114	>0.96	1610	1200	406	89	250	6.55	
4x18W SP 5 lamele	21334142	min. 0.92	703.5	520	703.5	89	520	4.70	
4x18W SP 9 lamele	21334132	min. 0.92	703.5	520	703.5	89	520	4.80	
4x18W SP 9 lamele HF-S	21334170	>0.96	703.5	520	703.5	89	520	4.15	
4x18W SP 9 lamele HF-P	21334317	>0.96	703.5	520	703.5	89	520	4.15	
4x18W DP 7 lamele	21334134	min. 0.92	703.5	520	703.5	89	520	4.80	
4x18W DP 7 lamele HF-S	21334173	>0.96	703.5	520	703.5	89	520	4.15	
4x18W DP 7 lamele HF-P	21334318	>0.96	703.5	520	703.5	89	520	4.15	
4x18W DR 7 lamele	21334153	min. 0.92	703.5	520	703.5	89	520	4.80	
4x18W DR 7 lamele HF-S	21334176	>0.96	703.5	520	703.5	89	520	4.15	
4x18W DR 7 lamele HF-P	21334316	>0.96	703.5	520	703.5	89	520	4.15	
4x36W SP	21344022	min. 0.92	1333	900	703.5	89	520	9.00	
4x36W DP	21344024	min. 0.92	1333	900	703.5	89	520	9.00	
4x58W DP	21354014	min. 0.92	1636	1100	703.5	86	520	12.00	
4x58W SP	21354012	min. 0.92	1636	1100	703.5	86	520	12.00	

\*lamele / lamellas

\*Codurile pentru produse echipate cu tuburi LED se regăsesc la pg. 252 / The product code for equipping with LED tube to be found on pg. 252



EN 60598-1 230V / 50Hz IP 40 IK 07 960°C RoHS 55W

**Domeniul de utilizare:** Iluminatul general de interior

**Descriere:**

**Corp:** Armătură din tablă de oțel vopsită cu pulbere

**Reflector:** Tablă de oțel vopsită cu pulbere

**Dispensor:** Tablă de oțel perforată vopsită cu pulbere

**Montaj:** Aparent

**Sursa:** Lampă compactă (LC) TC-L

**Dulie:** 2G11

**Standard:** SR EN 60598-1

**Application:** General indoor lighting

**Description:**

**Body:** Steel sheet body, painted with powder

**Reflector:** Steel sheet reflector painted with powder

**Diffuser:** Perforated steel sheet painted with powder

**Mounting:** Visible

**Source:** Compact lamp (LC) TC-L

**Socket:** 2G11

**Standard:** SR EN 60598-1

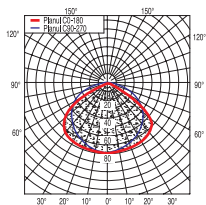

pg.289

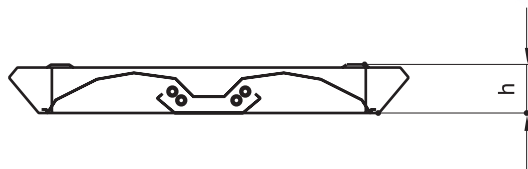
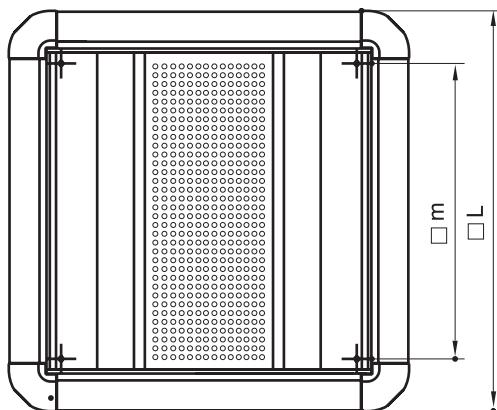

Tip/Type	Cod produs/ Product code	Factor de putere/ Power factor	Dimensiuni/Dimensions [mm]			Masa/ Weight [kg]	Lampa/ Lamp
			L	m	h		
2x55W	21372021	0.95	704.5	520	85	5.50	TC-L 



EN 60598-1	230V / 50Hz	IP 40	IK 07			960°C		RoHS	14W / 28W / 35W							
------------	-------------	-------	-------	--	--	-------	--	------	-----------------	--	--	--	--	--	--	--



**Domeniul de utilizare:** Iluminatul general de interior

**Descriere:**

**Corp:** Armătură din tablă de oțel vopsită cu pulbere

**Reflector:** Tablă de aluminiu oglindată, cu coeficient de reflexie > 0.85, dublu parabolic (DP)

La cerere poate fi echipat cu aparataj pentru iluminat de siguranță, reglaj de flux și bloc de conectare "PUSH-IN"

**Montaj:** Aparent

**Sursa:** Tub fluorescent (T5)

**Dulie:** G5

**Standard:** SR EN 60598-1

**Application:** General indoor lighting

**Description:**

**Body:** Steel sheet body, painted with powder

**Reflector:** Mirrored aluminum sheet reflector with a reflection factor > 0.85, double parabolic (DP)

On request may be equipped with emergency lighting kit, dimmable electronic ballast and block connector "PUSH-IN"

**Mounting:** Visible

**Source:** Tubular fluorescent lamp (T5)

**Socket:** G5

**Standard:** SR EN 60598-1



DP



conector PUSH-IN/  
connector

FIRA 07-414

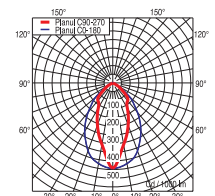
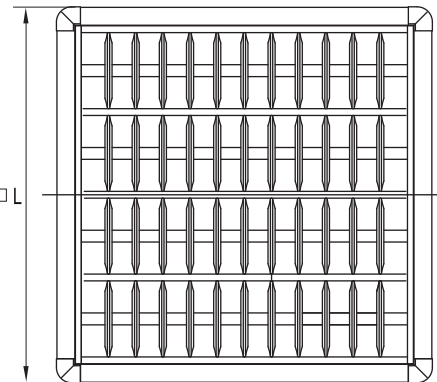
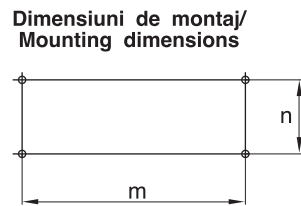
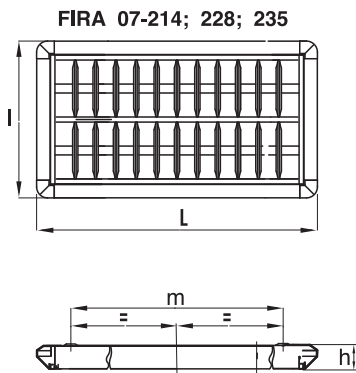

pg.290

Tip/Type	Cod produs/ Product code	Factor de putere/ Power factor	Dimensiuni/Dimensions [mm]					Masa/ Weight [kg]	Lampa/ Lamp
			L	m	l	h	n		
2x14W	21322012	min. 0.95	636	360	356	57.6	240	2.14	
2x28W	21322022	min. 0.95	1239	900	356	57.6	240	4.30	
1x35W	21321032	min. 0.95	1534	1100	214	57.6	80	4.66	
2x35W	21322032	min. 0.95	1534	1100	356	57.6	240	5.46	
4x14W	21324012	min. 0.95	630	360	630	57.6	360	4.70	

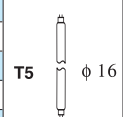



EN 60598-1 230V / 50Hz IP 40 IK 07 960°C 18W

**Domeniul de utilizare:** Iluminatul general de interior

**Descriere:**

**Corp:** Armătură din tablă de oțel vopsită cu pulbere

**Reflector (pentru varianta FIRA):** Tablă de aluminiu oglindată, cu coeficient de reflexie > 0.85. Geometrie: drept(D) cu 10 lamele transversale

**Grătar (pentru varianta FIRAG):** ABS alb

La cerere poate fi echipat cu balast electronic și reglaj de flux

**Montaj:** Aparent

**Sursa:** Tub fluorescent (T8)

**Dulie:** G13

**Standard:** SR EN 60598-1

**Application:** General indoor lighting

**Description:**

**Body:** Steel sheet body, painted with powder

**Reflector (FIRA type):** Mirrored aluminum sheet reflector with >0.85 reflection factor. Shape: flat(D) with 10 transversal lamellas

**Grid (FIRAG variant):** White ABS

On request may be fitted with electronic ballast (dimnable version also)

**Mounting:** Visible

**Source:** Tubular fluorescent lamp (T8)

**Socket:** G13

**Standard:** SR EN 60598-1



FIRA 07



FIRAG 07

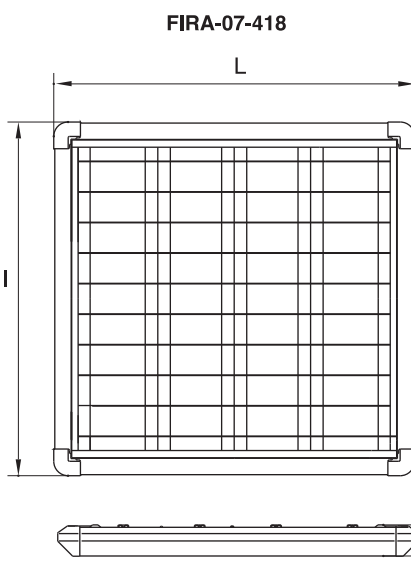

FIRA-07-418

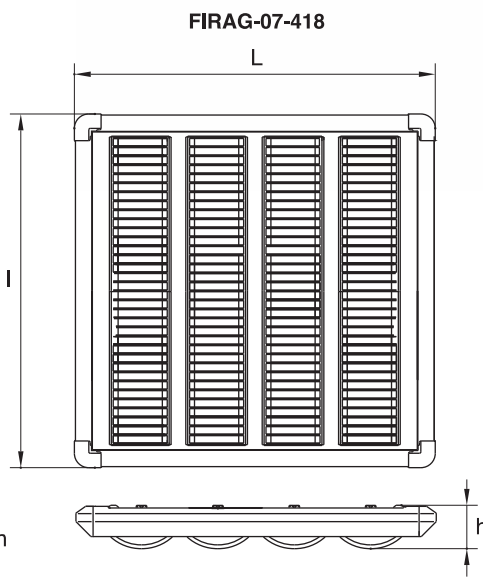

FIRAG-07-418

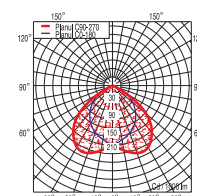
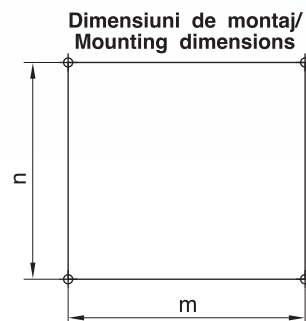

pg.290

**FIRA 07**

Tip/Type	Cod produs/ Product code	Factor de putere/ Power factor	Dimensiuni/Dimensions [mm]					Masa/ Weight [kg]	Lampa/ Lamp
			L	m	l	h	n		
4x18W	21334240	min. 0.92	661.5	520	648.5	57.4	450	4.40	T8 φ 26
4x18W HF-S	21334507	>0.96	661.5	520	648.5	57.4	450	3.75	
4x18W HF-P	21334395	>0.96	661.5	520	648.5	57.4	450	3.75	

**FIRAG 07**

Tip/Type	Cod produs/ Product code	Factor de putere/ Power factor	Dimensiuni/Dimensions [mm]					Masa/ Weight [kg]	Lampa/ Lamp
			L	l	h	m	n		
4x18W	21334241	min. 0.92	661.5	648.5	85	520	450	5.30	T8 φ 26

EN 60598-1 230V / 50Hz IP 40 IK 07 960°C CE RoHS 18W



NOU!  
NEW!



**Domeniul de utilizare:** Iluminatul general de interior

**Application:** General indoor lighting

**Descriere:**

**Description:**

**Corp:** Armătură din tablă de oțel vopsită cu pulbere gri

**Body:** Steel sheet body, painted with grey powder

**Reflector:** Simplu parabolic (SP) din tablă de aluminiu cu coeficient de reflexie > 0,85, cu 9 lamele transversale.

**Reflector:** Simple parabolic (SP) mirrored aluminum sheet reflector with >0.85 reflection factor, with 9 transversal lamellas

La cerere poate fi echipat cu tuburi fluorescente T5-14W; kit pentru iluminat de siguranță.

On request may be fitted with tubular T5-14W fluorescent lamp; safety kit.

**Montaj:** Aparent

**Mounting:** Visible

**Sursa:** Tub fluorescent (T8) și tuburi cu LED

**Source:** Tubular fluorescent lamp (T8) and tubular LED lamp

**Dulie:** G13

**Socket:** G13

**Standard:** SR EN 60598-1

**Standard:** SR EN 60598-1

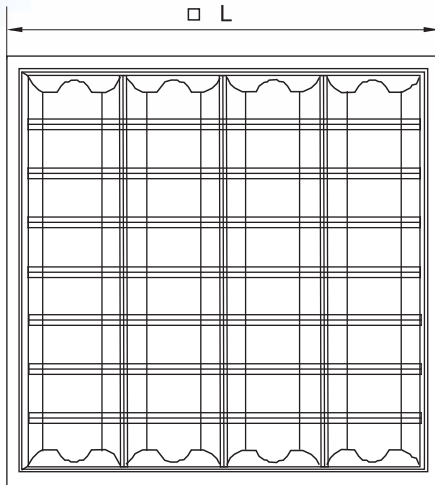

DP

SP

DR

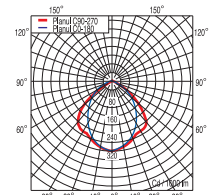

pg.291

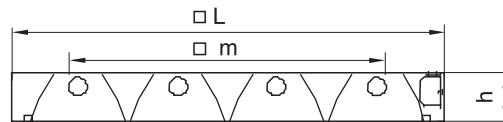

Tip/ Type	Cod produs / Product code	Factor de putere / Power factor	Dimensiuni/ Dimension [mm]					Culoare/ Colour	Masa/ Weight [kg]	Lampa/ Lamp
			L	l	h	m	n			
4x18W DR	21334371	min. 0,92	614	614	70	430	430	Gri / Grey	4.95	 T8  φ 26
4x18W SP	21334372	min. 0,92	614	614	70	430	430	Gri / Grey	4.95	
4x18W DP	21334373	min. 0,92	614	614	70	430	430	Gri / Grey	4.95	
4x18W DR HF-P	21334374	> 0,96	614	614	70	430	430	Gri / Grey	4.24	
4x18W SP HF-P	21334375	> 0,96	614	614	70	430	430	Gri / Grey	4.24	
4x18W DP HF-P	21334376	> 0,96	614	614	70	430	430	Gri / Grey	4.24	
4x18W DR HF-S	21334377	> 0,96	614	614	70	430	430	Gri / Grey	4.24	
4x18W SP HF-S	21334378	> 0,96	614	614	70	430	430	Gri / Grey	4.24	
4x18W DP HF-S	21334379	> 0,96	614	614	70	430	430	Gri / Grey	4.24	

\*Codurile pentru produse echipate cu tuburi LED se regăsesc la pg. 253 / The product code for equipping with LED tube to be found on pg. 253



**Domeniul de utilizare:** Iluminatul general de interior

**Descriere:**

**Corp:** Armătură din tablă de oțel vopsită cu pulbere

**Dispersor:** Din PMMA opal (O) sau transparent texturat (T)

La cerere poate fi echipat cu balast electronic cu reglaj de flux (cu excepția variantei 118, 218), aparataj pentru iluminat de siguranță, suspensii și bloc de conectare "PUSH-IN"

**Montaj:** Aparent

**Sursa:** Tub fluorescent (T8) și tuburi cu LED

**Dulie:** G13

**Standard:** SR EN 60598-1

**Application:** General indoor lighting

**Description:**

**Body:** Steel sheet body, painted with powder

**Diffuser:** Opal (O) or transparent patterned (T) PMMA

On request may be fitted with dimmable electronic ballast (except for the 118 and 218 variants), emergency lighting kit, suspensions and block connector "PUSH-IN"

**Mounting:** Visible

**Source:** Tubular fluorescent lamp (T8) and tubular LED lamp

**Socket:** G13

**Standard:** SR EN 60598-1

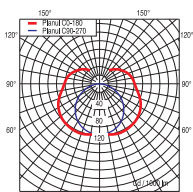

conector PUSH-IN/  
connector

pg.291

FIDA-05-218 O; 236 O  
FIDA-05-218 T; 236 T

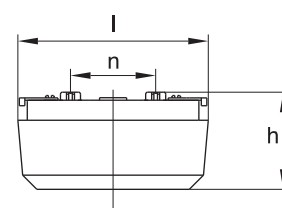
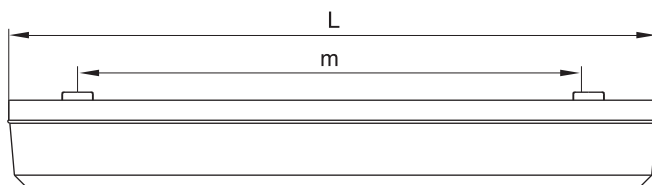

EN 60598-1	230V / 50Hz	IP 40	IK 05			960°C	CE	RoHS	18W / 36W
------------	-------------	-------	-------	--	--	-------	----	------	-----------

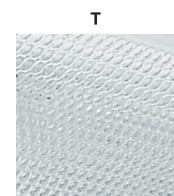
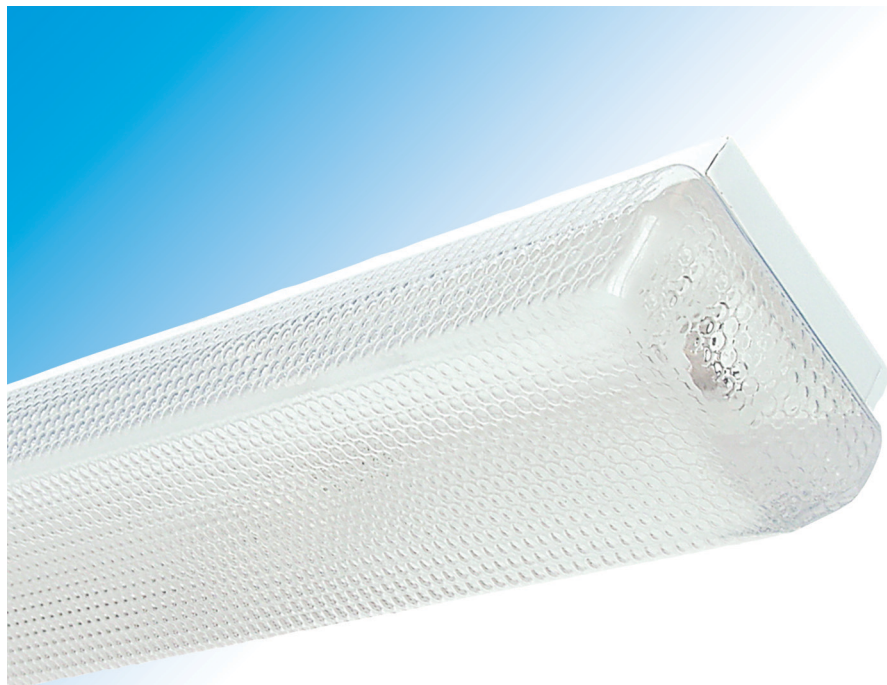

conector  
PUSH-IN/  
connector

Tip/Type	Cod produs/ Product code	Factor de putere/ Power factor	Dimensiuni/Dimensions [mm]					Masa/ Weight [kg]	Lampa/ Lamp
			L	m	l	h	n		
1x18W opal	21431057	min. 0.92	650	450	107	97	-	1.48	 T8 φ 26
1x18W opal HF-S	21431122	>0.96	650	450	107	97	-	1.25	
1x18W opal HF-P	21431070	>0.96	650	450	107	97	-	1.25	
1x18W transparent	21431055	min. 0.92	650	450	107	97	-	1.48	
1x18W transparent HF-S	21431121	>0.96	650	450	107	97	-	1.25	
1x18W transparent HF-P	21431068	>0.96	650	450	107	97	-	1.25	
1x36W opal	21441057	min. 0.92	1256	900	107	97	-	2.20	
1x36W opal HF-S	21441070	>0.96	1256	900	107	97	-	1.95	
1x36W opal HF-P	21441151	>0.96	1256	900	107	97	-	1.95	
1x36W transparent	21441055	min. 0.92	1256	900	107	97	-	2.20	
1x36W transparent HF-S	21441068	>0.96	1256	900	107	97	-	1.95	
1x36W transparent HF-P	21441150	>0.96	1256	900	107	97	-	1.95	
2x18W opal	21432059	min. 0.92	650	450	191	97	85	1.80	
2x18W opal HF-S	21432090	>0.96	650	450	191	97	85	1.60	
2x18W opal HF-P	21432070	>0.96	650	450	191	97	85	1.60	
2x18W transparent	21432057	min. 0.92	650	450	191	97	85	1.80	
2x18W transparent HF-S	21432089	>0.96	650	450	191	97	85	1.60	
2x18W transparent HF-P	21432068	>0.96	650	450	191	97	85	1.60	
2x36W opal	21442104	min. 0.92	1256	900	191	97	85	3.50	
2x36W opal HF-S	21442116	>0.96	1256	900	191	97	85	2.80	
2x36W opal HF-P	21442169	>0.96	1256	900	191	97	85	2.80	
2x36W transparent	21442102	min. 0.92	1256	900	191	97	85	3.50	
2x36W transparent HF-S	21442114	>0.96	1256	900	191	97	85	2.80	
2x36W transparent HF-P	21442168	>0.96	1256	900	191	97	85	2.80	
4x18W opal	21434094	min. 0.92	670	480	670	105	480	5.90	
4x18W opal HF-S	21434104	>0.96	670	480	670	105	480	5.25	
4x18W opal HF-P	21434160	>0.96	670	480	670	105	480	5.25	
4x18W transparent	21434092	min. 0.92	670	480	670	105	480	5.90	
4x18W transparent HF-S	21434102	>0.96	670	480	670	105	480	5.25	
4x18W transparent HF-P	21434159	>0.96	670	480	670	105	480	5.25	

\*transparent texturat - transparent patterned opal / opal

\*Codurile pentru produse echipate cu tuburi LED se regăesc la pg. 252 / The product code for equipping with LED tube to be found on pg. 252





EN 60598-1	230V / 50Hz	IP 40	IK 05	⊕	▽	960°C	CE	RoHS	18W / 36W
------------	-------------	-------	-------	---	---	-------	----	------	-----------

**Domeniul de utilizare:** Iluminatul general de interior

**Descriere:**

**Corp:** Armătură din tablă de oțel vopsită cu pulbere

**Dispensator:** Placă opală (O) sau transparent texturat (T) din PMMA

La cerere poate fi echipat cu balast electronic, aparataj pentru iluminat de siguranță, reglaj de flux, suspensii și bloc de conectare "PUSH-IN"

**Montaj:** Aparent

**Sursa:** Tub fluorescent (T8) și tuburi cu LED

**Dulie:** G13

**Standard:** SR EN 60598-1

**Application:** General indoor lighting

**Description:**

**Body:** Steel sheet body, painted with powder

**Diffuser:** Opal (O) or transparent patterned (T) plate of PMMA

On request may be fitted with electronic ballast (dimmable version also), emergency lighting kit, suspensions and block connector "PUSH-IN"

**Mounting:** Visible

**Source:** Tubular fluorescent lamp (T8) and tubular LED lamp

**Socket:** G13

**Standard:** SR EN 60598-1

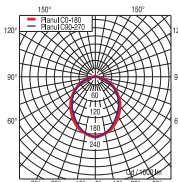

conector PUSH-IN/connector

pg.292

FIDA-12-236 O; 236 P

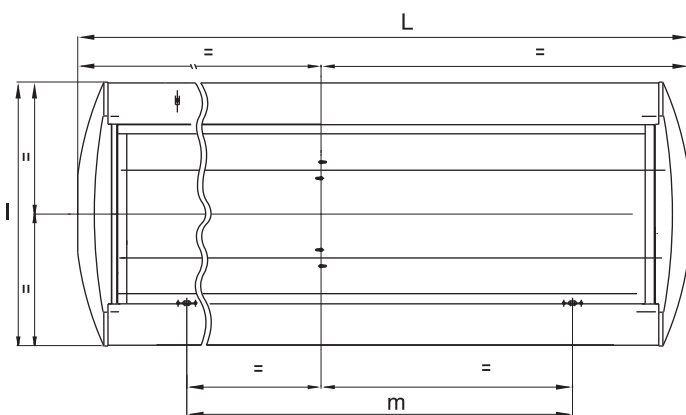

FIDA-12-418 O; 418 P

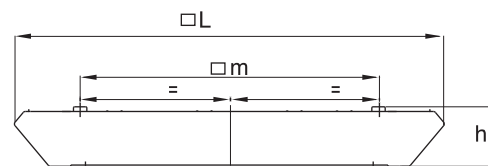

Tip/Type	Cod produs/ Product code	Factor de putere/ Power factor	Dimensiuni/Dimensions [mm]					Masa/ Weight [kg]	Lampa/ Lamp
			L	m	l	h	n		
2x36W opal	21442122	min. 0.92	1306	950	406	89	250	5.6	T8
2x36W transparent	21442121	min. 0.92	1306	950	406	89	250	5.6	
4x18W opal	21434110	min. 0.92	704	520	704	89	-	6.6	 φ 26
4x18W transparent	21434108	min. 0.92	704	520	704	89	-	6.6	

\*transparent texturat - transparent patterned opal / opal

\*Codurile pentru produse echipate cu tuburi LED se regăsesc la pg. 252 / The product code for equipping with LED tube to be found on pg. 252

**EN 60598-1** **230V / 50Hz** **IP 20** **IP 40** **IK 07** **RoHS** **28W**

FIRAS FIRA

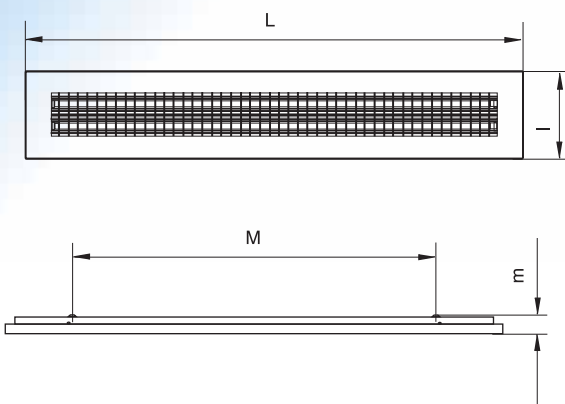
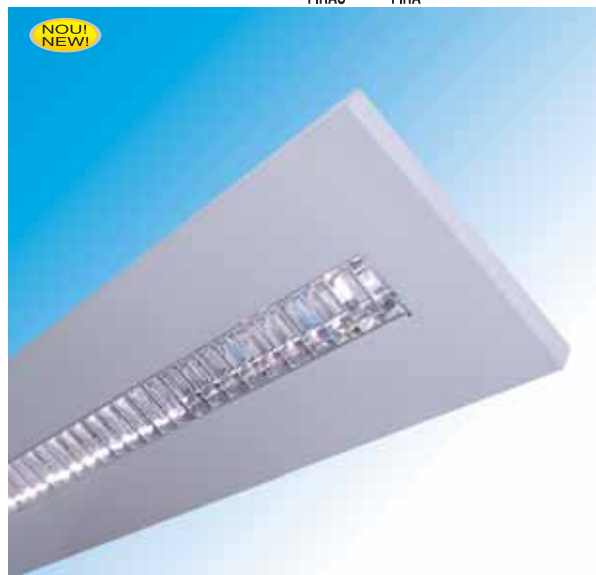
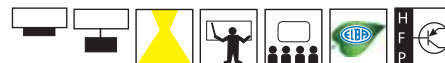

**Domeniul de utilizare:** Iluminat general de interior

**Descriere:**  
**Corp:** Armătură din tablă de oțel vopsită cu pulbere gri

**Reflector:** Dublu parabolic (DP) din tablă de aluminiu oglindată

**Montaj:** Aparent (FIRA 14)  
Suspendat (FIRAS 14)

**Sursa:** Tub fluorescent (T5)

**Dulie:** G5

**Standard:** SR EN 60598-1

**Application:** General indoor lighting.

**Description:**

**Body:** Steel sheet body painted with grey powder

**Reflector:** Mirrored double parabolic (DP) aluminum sheet

**Mounted:** Visible (FIRA 14)  
Suspended (FIRAS 14)

**Source:** Tubular fluorescent lamp (T5)

**Socket:** G5

**Standard:** SR EN 60598-1



DP



FIRAS 14  
Suspensii/  
suspension  
cables

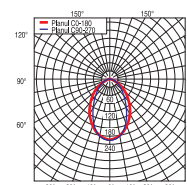

pg.293

Tip/Type	Cod produs/ Product code	Factor de putere/ Power factor	Dimensiuni/Dimensions [mm]				Masa/ Weight [kg]	Lampa/ Lamp
			L	I	M	m		
1x28W	21321024	>0.96	1300	228	950	48	3.40	 T5 16
2x28W	21322029	>0.96	1300	228	950	48	3.40	
1x28W suspendat / suspended	21321025	>0.96	1300	228	950	48	3.70	
2x28W suspendat / suspended	21322030	>0.96	1300	228	950	48	3.70	





EN 60598-1	230V / 50Hz	IP 40	IK 07			960°C		RoHS	18W
------------	-------------	-------	-------	--	--	-------	--	------	-----

**Domeniul de utilizare:** Iluminatul general de interior

**Application:** General indoor lighting

**Descriere:**

**Corp:** Armătură din tablă de oțel vopsită cu pulbere albă, ornamente din tablă oțel vopsit gri

**Description:**

**Body:** Steel sheet body, painted with white powder, steel sheet ornaments painted grey

**Reflector:**

- simplu parabolic (SP)  
- dublu parabolic (DP) cu coeficient de reflexie 0.85, în variante cu 3, 4, 5 sau 9 lamele

**Reflector:**

- simple parabolic (SP)  
- double parabolic (DP) with 0.85 reflection factor in variants with 3, 4, 5 or 9 lamellas

La cerere poate fi echipat cu balast electronic, aparataj pentru iluminat de siguranță, reglaj de flux și bloc de conectare "PUSH-IN"

On request may be fitted with electronic ballast (dimnable version also), emergency lighting kit and block connector "PUSH-IN"

**Montaj:** Aparent

**Mountig:** Visible

**Sursa:** Tub fluorescent (T8) și tuburi cu LED

**Source:** Tubular fluorescent lamp (T8) and tubular LED lamp

**Dulie:** G13

**Socket:** G13

**Standard:** SR EN 60598-1

**Standard:** SR EN 60598-1

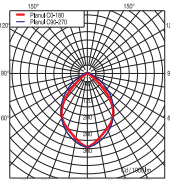

pg.295

conector PUSH-IN/  
connector



DP



SP

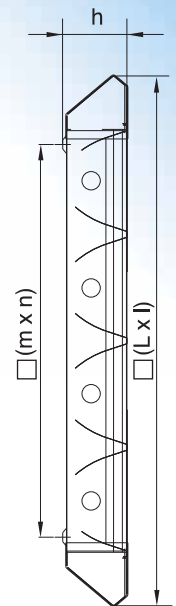
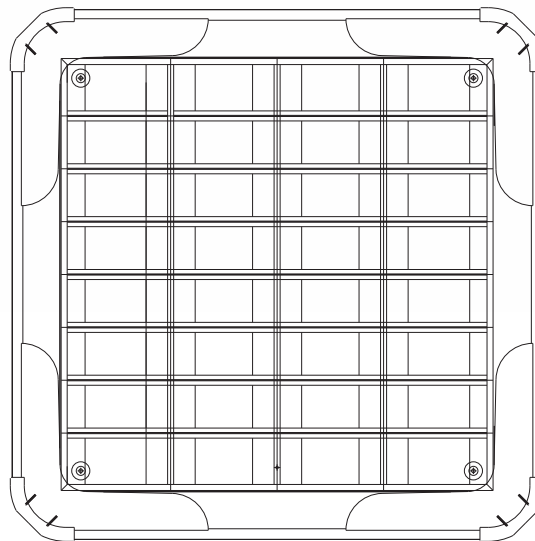

Tip/Type	Cod produs/ Product code	Factor de putere/ Power factor	Dimensiuni/Dimensions [mm]				Masa/ Weight [kg]	Lampa/ Lamp	
			L	l	h	m			n
4x18W SP cu ornament / with ornament	21334302	0.92	701.5	701.5	86	520	520	6.50	T8

\*Codurile pentru produse echipate cu tuburi LED se regăsesc la pg. 252 / The product code for equipping with LED tube to be found on pg. 252



**EN 60598-1 230V / 50Hz IP 40 IK 07** **RoHS 18W / 36W / 58W**



**Domeniul de utilizare:** Iluminat general de interior

**Application:** General indoor lighting.

**Descriere:**

**Corp:** Armătură din tablă de oțel vopsită cu pulbere gri, colțare din ABS negru

**Description:**

**Body:** Steel sheet body painted with grey powder, ABS corner pieces

**Reflector:** Dublu parabolic (DP) din tablă de aluminiu oglindată cu coeficient de reflexie 0.85, sau simplu parabolic

**Reflector:** Mirrored double parabolic (DP) aluminum sheet reflector with 0.85 reflexion factor, or simple parabolic

La cerere toate variantele pot fi echipate cu: balast electronic standard (HF-S), performant (HF-P), reglabil (HF-R)

On request all products may be fitted with: standard electronic ballast (HF-S), high-performance electronic ballast (HF-P), or dimmable electronic ballast (HF-R)

**Montaj:** Aparent

**Mounting:** Visible

**Sursa:** Tub fluorescent (T8) și tuburi cu LED

**Source:** Tubular fluorescent lamp (T8) and tubular LED lamp

**Dulie:** G13

**Socket:** G13

**Standard:** SR EN 60598-1

**Standard:** SR EN 60598-1

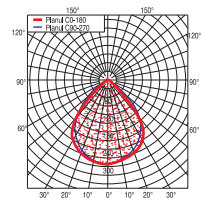
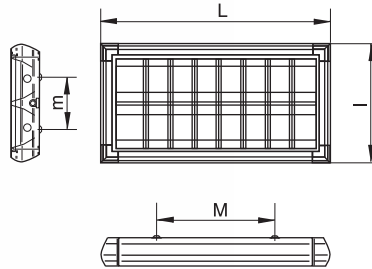

pg.296

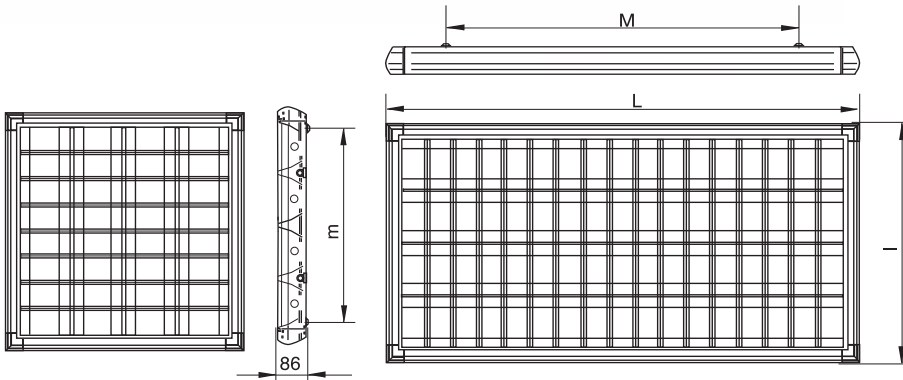

DP



SP

Tip/Type	Cod produs/ Product code	Factor de putere/ Power factor	Dimensiuni/Dimensions [mm]				Masa/ Weight [kg]	Lampa/ Lamp
			L	I	M	m		
2x36W DP	21342232	0.94	1270	343	950	150	 T8  φ 26	
2x36W DP HF-P	21342234	0.98	1270	343	950	150		
4x18W DP	21334322	0.97	640	640	430	430		
4x18W DP HF-P	21334325	0.98	640	640	430	430		
2x18W SP	21332131	0.89	660	343	340	150		
2x18W DP	21332132	0.89	660	343	340	150		
2x18W DP HF-P	21332134	0.98	660	343	340	150		
2x18W DP HF-R	21332136	0.97	660	343	340	150		
2x36W SP	21342231	0.94	1270	343	950	150		
2x36W DP HF-R	21342236	0.95	1270	343	950	150		
2x36W DP HF-S	21342238	0.95	1270	343	950	150		
4x18W SP	21334320	0.97	640	640	430	430		
4x18W DP HF-R	21334412	0.95	640	640	430	430		
4x58W SP	21354022	0.92	1572	640	950	340		
4x58W DP	21354023	0.92	1572	640	950	340		

\*Codurile pentru produse echipate cu tuburi LED se regăsesc la pg. 253 / The product code for equipping with LED tube to be found on pg. 253