

Fișă tehnică produs

Specificatii



Baliza, fara Sirena, 12~24V C.C., Verde

XVR3B03

Principale

gama de produse	Harmony XVR
Tip produs sau componenta	Girofar
nume scurt al dispozitivului	XVR3
unitate tip far sau baterie de indicatoare	Unitate LED
diametrul de montaj	100 mm
sursa de lumina	LED, verde
aplicatie a dispozitivului	Stivuiitor Buldozer Vehicul cu ghidare automată (AGV)

Suplimentare

tip semnalizare	Intermitent Rotativ Intermitent
stil de asamblare	Gata asamblate
Material	PC (policarbonat): lentile PBT (polibutilenă tereftalată) + PC (policarbonat): corpul dispozitivului EPDM: baza
[Us] tensiune nominala de alimentare	12...24 V c.c.
[Ue] tensiune nominala de functionare	10...30 V c.c.
curentul de varf	3 A
putere consumata in W	2,8 W
marcaj	CE
directia de instalare	Drept de interior Lateral de interior Inversat de interior Drept de exterior
clasa de izolatie electrica	Clasa II
consum de curent	3000 mA
lungime	100 mm
latime	100 mm
inaltime	139 mm
greutate produs	0,484 kg

Mediu

temperatura ambientala de functionare	-20...50 °C
---------------------------------------	-------------

temperatura ambietala pentru depozitare	-35...70 °C
umiditate relativa	35...85 % fără condensare
rezistenta la vibratii	4.6 gn (lateral) 4.6 gn (inversat) 7.1 gn (drept)
grad de protectie IP	IP65 (drept) IP23 (lateral) IP23 (inversat)

Unitati de ambalare

Unitate de masura pentru prima forma de impachetare	PCE
Număr de produse în pachet	1
Inaltime prima forma de impachetare	18,300 cm
Latime prima forma de impachetare	13,700 cm
Lungime prima forma de impachetare	13,500 cm
Greutate colet(Lbs)	637,000 g
Unitate de masura pentru a doua forma de impachetare	S04
Numar unitati in a doua forma de impachetare	8
Inaltime a doua forma de impachetare	30,000 cm
Latime a doua forma de impachetare	40,000 cm
Lungime a doua forma de impachetare	60,000 cm
Greutate a doua forma de impachetare	5,992 kg

Garanție contractuală

Garantie (in luni)	18
--------------------	----

Schneider Electric isi propune sa atinga nivelul Net Zero pana in 2050 prin parteneriate la nivelul lantului de aprovizionare, materiale cu impact mai redus si circularitate, prin campania „Use Better, Use Longer, Use Again” pentru a extinde durata de viata a produselor si reciclabilitatea.

[Environmental Data explicate >](#)

[Cum evaluam sustenabilitatea produselor >](#)

Amprenta de mediu

Raport de mediu

[Profilul ambiental al produsului](#)

Use Better

Materiale si ambalare

Pachet cu carton reciclabil

Da

Ambalaj fara plastic

Da

Directiva RoHS a UE

[Conform Prin Scutire](#)

Regulamentul REACH

[Referinta contine SVHC peste prag](#)

Use Longer

Prelungire durata de viata

Reparare

Nu

Use Again

Reambalare si refabricare

Profil circularitate

[Informatii privind sfarsitul duratei de viata](#)

Preluare la sfarsitul duratei de viata

Da

Eticheta WEEE



În Uniunea Europeana, produsele trebuie reciclate respectand sistemul specific de colectare a deseurilor si nu trebuie sa ajunga in pubelele de colectare a deseurilor menajere.

Dimensions Drawings

Dimensions

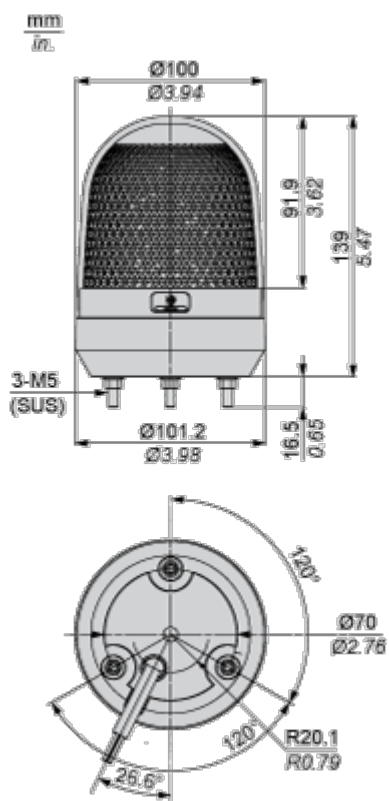

Mounting and Clearance

Panel Cut-out

Straight wiring

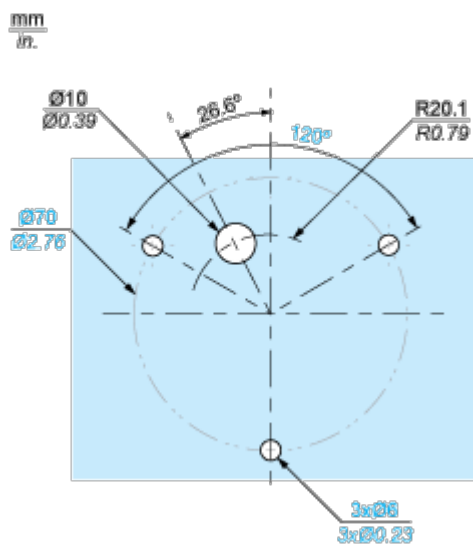

Side wiring

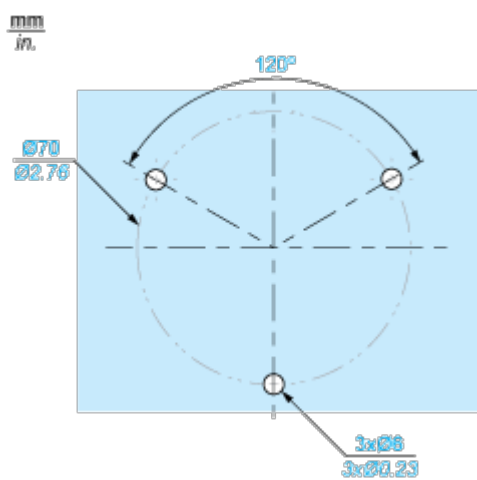

Connections and Schema

Wiring Diagram

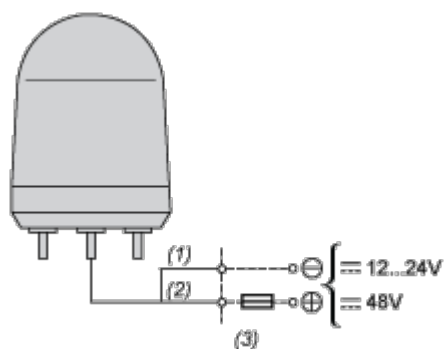

- (1) Black
- (2) White
- (3) Fuse(Rated Current>2A)

Technical Illustration

Wiring diagram

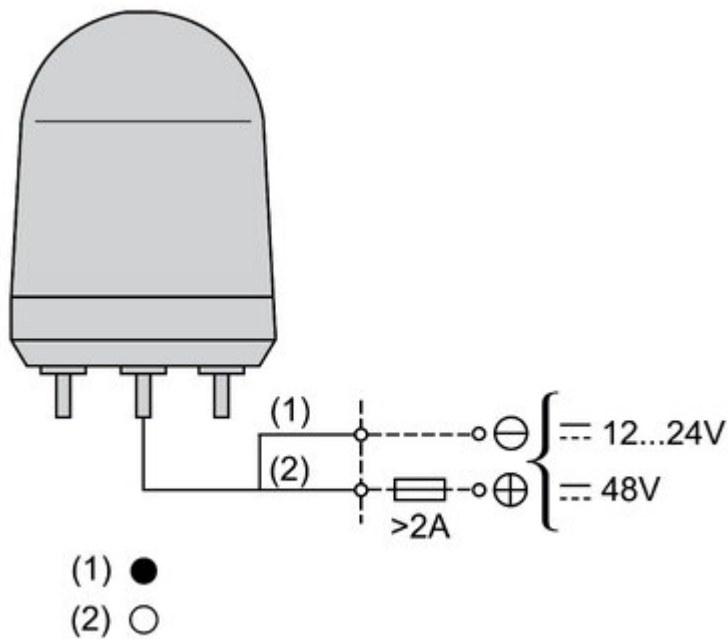

Offer Marketing Illustration

Product benefits / Features

Technical Benefits

Harmony XVR3

Conforms with international IEC standards as well as CE, UL and CCC marking

Protection ratings up to IP65 and vibration resistance to increase reliability



Can be mounted in diverse positions: upright, sideways, and inverted

Motor-less super-bright LED with 360° visibility



Operating temperature from -10 °C to 50 °C

Offer Marketing Illustration

Product benefits / Features



The infographic features a central image of a blue, dome-shaped industrial light fixture with a black base, set against a green background. The base has the Schneider Electric logo. Surrounding the central image are five circular icons, each with a corresponding text block describing a feature. The features are: 1. A leaf icon for '4 colors with 10 light patterns to select with one switch'. 2. A wrench and screwdriver icon for 'Simplified installation (pre-cabled and pre-assembled products) and easy maintenance'. 3. A lightbulb icon for 'High visibility of machine status'. 4. A speaker icon for 'Buzzer volume adjustment through a built-in switch'. 5. A vertical scale icon for 'Available in various diameters to suit different industrial applications'.

Features

Harmony XVR3

- 4 colors with 10 light patterns to select with one switch
- Simplified installation (pre-cabled and pre-assembled products) and easy maintenance
- High visibility of machine status
- Buzzer volume adjustment through a built-in switch
- Available in various diameters to suit different industrial applications

Image of product / Alternate images

Alternative

