



Auxiliary switch, 1 NO+1 NC, with gold-plated contacts, accessory for main and emergency switching-off 3LD2 front mounting and for molded case switch 3LD5 UL front mounting

Model	
product brand name	SETRON
product designation	auxiliary switch
design of the product	accessories for 3LD2 main and EMERGENCY-STOP switches, front mounting
operational current	<ul style="list-style-type: none"> at AC-15 at 110 V rated value: 6 A at AC-15 at 230 V rated value: 3 A at AC-15 at 500 V rated value: 1.4 A at DC-13 at 24 V rated value: 4 A
suitability for use	for 3LD2 front mounting and 3LD5 UL front mounting
special product feature	NO: lagging during switching ON, leading during switching OFF the 3LD switch. NC: leading during switching ON, lagging during switching OFF the 3LD switch

Accessories	
accessories	auxiliary switch, 1 NO + 1 NC, with gold-plated contacts
tightening torque with screw-type terminals	<ul style="list-style-type: none"> minimum: 0.8 N·m maximum: 1.2 N·m
type of connectable conductor cross-sections for auxiliary contacts	<ul style="list-style-type: none"> solid: 2x (0.75-2.5 mm²), 1x 4 mm² finely stranded with core end processing: 2x (0.75-2.5 mm²), 1x 4 mm² stranded: 2x (0.75-2.5 mm²), 1x 4 mm²

Mechanical Design	
Net Weight	21 g

Approvals Certificates	
Environment	General Product Approval

[Environmental Confirmations](#)

[Environmental Confirmations](#)



General Product Approval

[Confirmation](#)



[Miscellaneous](#)





[Confirmation](#)

Further information

Information on the packaging

<https://support.industry.siemens.com/cs/ww/en/view/109813875>

Information for data generation and storage

<https://support.industry.siemens.com/cs/ww/en/view/109995012>

Information- and Downloadcenter (Catalogs, Brochures,...)

<https://www.siemens.com/lowvoltage/catalogs>

Industry Mall (Online ordering system)

<https://mall.industry.siemens.com/mall/en/en/Catalog/product?mlfb=3LD9200-5BF>

Service&Support (Manuals, Certificates, Characteristics, FAQs,...)

<https://support.industry.siemens.com/cs/ww/en/ps/3LD9200-5BF>

Image database (product images, 2D dimension drawings, 3D models, device circuit diagrams, ...)

https://www.automation.siemens.com/bilddb/cax_en.aspx?mlfb=3LD9200-5BF

CAX-Online-Generator

<https://www.siemens.com/cax>

Tender specifications

<https://www.siemens.com/specifications>

Characteristic curves

[https://curves.simaris.siemens.com/curves/<mmp_prod_noCOMP="HAUPT"></mmp_prod_no>](https://curves.simaris.siemens.com/curves/<mmp_prod_noCOMP=)

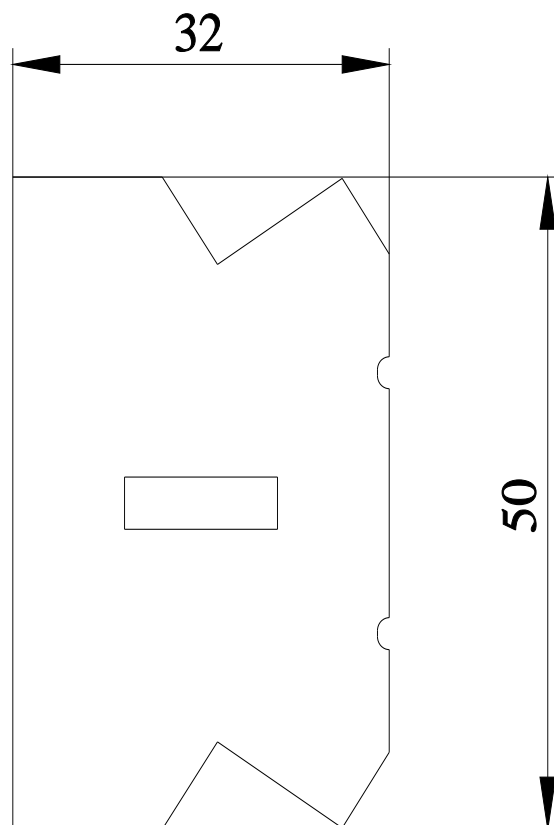
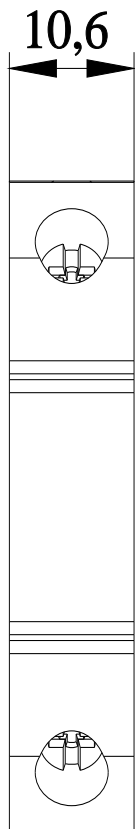

last modified:

4/12/2025

