

# Fișă tehnică produs

Specificatii



## Contact Bloc 1No Arc Terminal

ZBE1015

### Principale

<b>gama de produse</b>	Harmony XB5 Harmony XB4
<b>Tip produs sau componenta</b>	Bloc de contacte
<b>nume scurt al dispozitivului</b>	ZBE
<b>cantitate indivizibila de vanzare</b>	5
<b>grad de protectie IP</b>	IP20 conformitate cu SR EN 60529
<b>operare contacte</b>	Decuplare lenta
<b>tip bloc de contacte</b>	Monofilar
<b>utilizare contacte</b>	Contacte standard
<b>conexiuni - borne</b>	Push-in, $\leq 2 \times 1.5 \text{ mm}^2$ with wire end ferrule conformitate cu IEC 60947-1 Push-in, $\geq 1 \times 0.34 \text{ mm}^2$ without wire end ferrule conformitate cu IEC 60947-1

### Suplimentare

<b>CAD latime globala</b>	34,3 mm
<b>CAD inaltime globala</b>	14,8 mm
<b>CAD adancime globala</b>	9,8 mm
<b>greutate produs</b>	0,005 kg
<b>tip si compozitie contacte</b>	1 NO
<b>deschidere pozitiva</b>	Fara
<b>cursa de operare</b>	2,05 mm (modificarea stării electrice NO) 4,3 mm (cursă totală)
<b>forta de actionare</b>	2,45 N modificarea stării electrice NO
<b>durabilitate mecanica</b>	10000000 cic
<b>Material contacte</b>	Aliaj de argint (Ag/Ni)
<b>protectie la scurtcircuit</b>	10 A cartuş fuzibil tip gG conformitate cu SR EN 60947-5-1
<b>[Ith] curent termic conventional in aer liber</b>	10 A conformitate cu SR EN 60947-5-1
<b>[Ui] tensiune nominala de izolatie</b>	300 V (grad de poluare 3) conformitate cu IEC 60947-1
<b>[Uimp] tensiune de tinere la impuls</b>	4 kV conformitate cu IEC 60947-1
<b>[Ie] curent nominal de utilizare</b>	6 A la 120 V, AC-15, A300 conformitate cu SR EN 60947-5-1 3 A la 240 V, AC-15, A300 conformitate cu SR EN 60947-5-1 0,55 A la 125 V, DC-13, Q300 conformitate cu SR EN 60947-5-1 0,27 A la 250 V, DC-13, Q300 conformitate cu SR EN 60947-5-1
<b>montarea cutiei de borne</b>	Montajin fata
<b>prezentare dispozitiv</b>	Element de baza

## Mediu

tratament protector	TH
temperatura ambietala pentru depozitare	-40...70 °C
temperatura ambientală de functionare	-40...70 °C
standarde	IEC 60947-1 SR EN 60947-5-1 SR EN 60947-5-4 IEC 60947-5-5 UL 61010-1 UL 60947-5-1 UL 60947-5-5 UL 1059 UL 486E CSA C22.2 No 60947-1 CSA C22.2 No 60947-5-1 CSA C22.2 No 158 CSA C22.2 No 65 IACS E10
certificari produs	EAC IECEE CB Scheme CCC UL CSA
rezistenta la vibratii	5 gn (f= 10...500 Hz) conforming to IEC 60068-2-6 25 mm peak to peak (f= 2...10 Hz) conforming to IEC 60068-2-6
rezistenta la socuri	25 gn (durata = 6 ms) pentru 1000 shocks on each axis conformitate cu IEC 60068-2-27 30 gn (durata = 18 ms) pentru half sine wave acceleration conformitate cu IEC 60068-2-27 50 gn (durata = 11 ms) pentru half sine wave acceleration conformitate cu IEC 60068-2-27

## Unitati de ambalare

Unitate de masura pentru prima forma de impachetare	PCE
Număr de produse în pachet	1
Inaltime prima forma de impachetare	1,100 cm
Latime prima forma de impachetare	2,000 cm
Lungime prima forma de impachetare	3,500 cm
Greutate colet(Lbs)	5,000 g
Unitate de masura pentru a doua forma de impachetare	BB1
Numar unitati in a doua forma de impachetare	5
Inaltime a doua forma de impachetare	3,500 cm
Latime a doua forma de impachetare	4,500 cm
Lungime a doua forma de impachetare	5,500 cm
Greutate a doua forma de impachetare	30,000 g
Unitate de masura pentru a treia forma de impachetare	S02
Numar unitati in a treia forma de impachetare	500
Inaltime a treia forma de impachetare	15,000 cm
Latime a treia forma de impachetare	30,000 cm
Lungime a treia forma de impachetare	40,000 cm

---

Greutate a treia forma de impachetare	3,292 kg
--	----------

## Garanție contractuală

---

Garantie (in luni)	18
--------------------	----

Schneider Electric își propune să atingă nivelul Net Zero până în 2050 prin parteneriate la nivelul lanțului de aprovizionare, materiale cu impact mai redus și circularitate, prin campania „Use Better, Use Longer, Use Again” pentru a extinde durata de viață a produselor și reciclabilitatea.

[Environmental Data explicate >](#)

[Cum evaluăm sustenabilitatea produselor >](#)

### **Amprenta de mediu**

Amprenta de carbon totală pe durata de viață	0.1 kg CO2 eq.
Amprenta de carbon a fazei de fabricație [A1–A3]	0.1 kg CO2 eq.
Amprenta de carbon a fazei de distribuție [A4]	0 kg CO2 eq.
Amprenta de carbon a fazei de instalare [A5]	0 kg CO2 eq.
Amprenta de carbon a fazei de utilizare [B2, B3, B4, B6]	0 kg CO2 eq.
Amprenta de carbon a fazei de sfârșit de viață [C1–C4]	0 kg CO2 eq.

### **Use Better**

#### **Materiale și ambalare**

Procentul mediu de conținut de plastic reciclat	23 %
Procentul mediu de conținut de metal reciclat	13 %
Pachet cu carton reciclabil	Da
Ambalaj fără plastic	Da
Directiva RoHS a UE	<a href="#">Conform</a>
Regulamentul REACH	<a href="#">Referința nu conține SVHC peste prag</a>

### **Use Longer**

#### **Prelungire durată de viață**

Reparare	Nu
----------	----

### **Use Again**

#### **Reambalare și refabricare**

Potentialul de reciclabilitate, în %	50
Profil circularitate	<a href="#">Informații privind sfârșitul duratei de viață</a>
Preluare la sfârșitul duratei de viață	Da
Eticheta WEEE	 În Uniunea Europeană, produsele trebuie reciclate respectând sistemul specific de colectare a deșeurilor și nu trebuie să ajungă în pubelele de colectare a deșeurilor menajere.

Dimensions Drawings

Dimensions

---

with ZB5AZ009 Fixing Collar

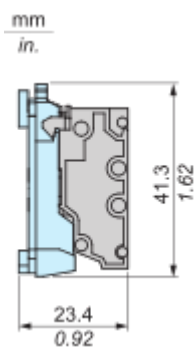

with ZB4BZ009 Fixing Collar

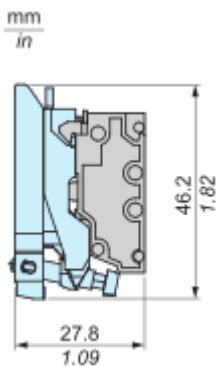

Mounting and Clearance

Mounting

---

Mounting and Unmounting



Panel cut-out Dimension

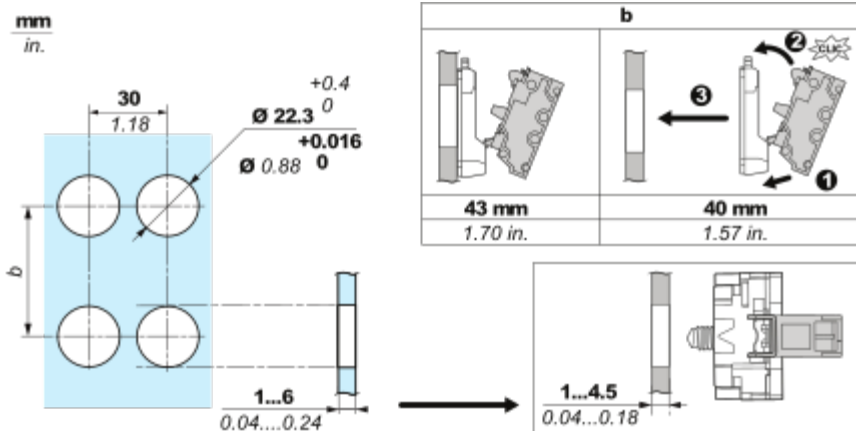

## Connections and Schema

### Wiring

#### Wiring and Unwiring



mm	8
in.	0.32
mm <sup>2</sup>	0.34...1.5
AWG	22...16

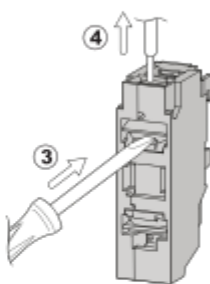
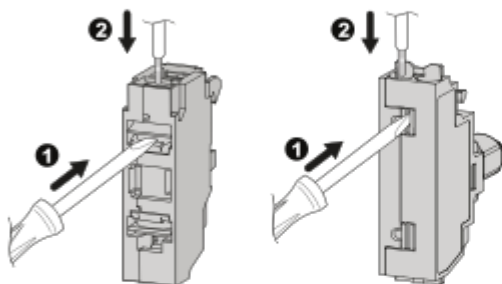

mm	8	8	8
in.	0.32	0.32	0.32
mm <sup>2</sup>	0.34...1.5	0.34...1	0.34...1.5
AWG	22...16	22...18	22...16

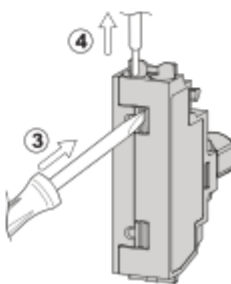
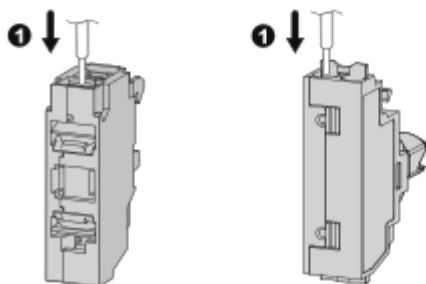

Technical Illustration

Dimensions

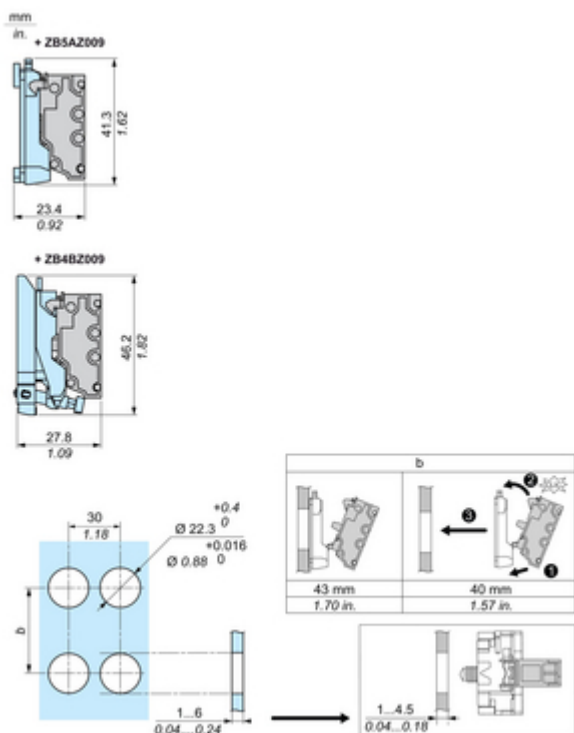

Technical Illustration

Wiring diagram

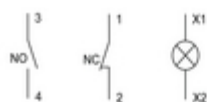

mm	8
in.	0.32
mm <sup>2</sup>	0.34...1.5
AWG	22...16

Max	0.8 mm
	0.031 in.
	2.4 mm
	0.09...0.157 in.

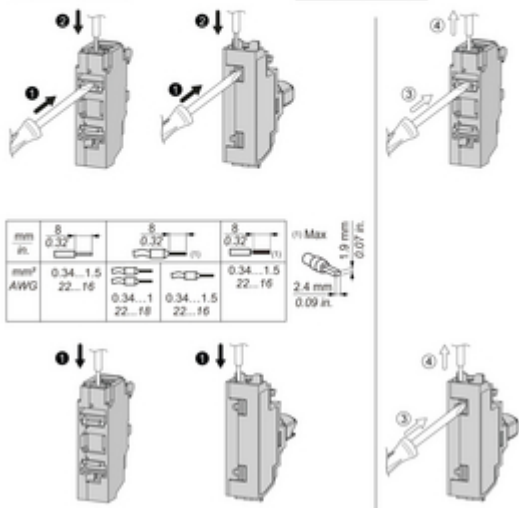

Offer Marketing Illustration

Product benefits / Features

---

### Technical Benefits

#### Harmony XB4/XB5 Compact Push-in blocks

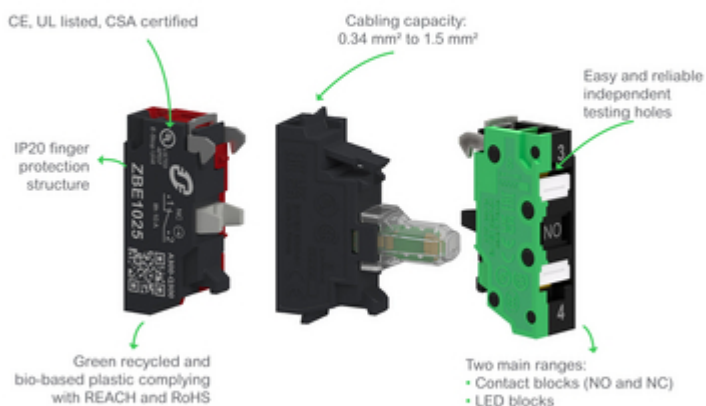



Offer Marketing Illustration

Product benefits / Features

---

**Features**  
Harmony XB4/XB5 Compact Push-in blocks



- 

37% thinner than a standard block
- 

Installation costs saved through reduced wiring time and effort
- 

Fully compatible with current Harmony offer
- 

Available as single block, sub-assemblies and complete units (both plastic and metal ranges)
- 

Simplified inventory management

Offer Marketing Illustration

Product benefits / Features

---

### Technical Benefits

#### Harmony XB4

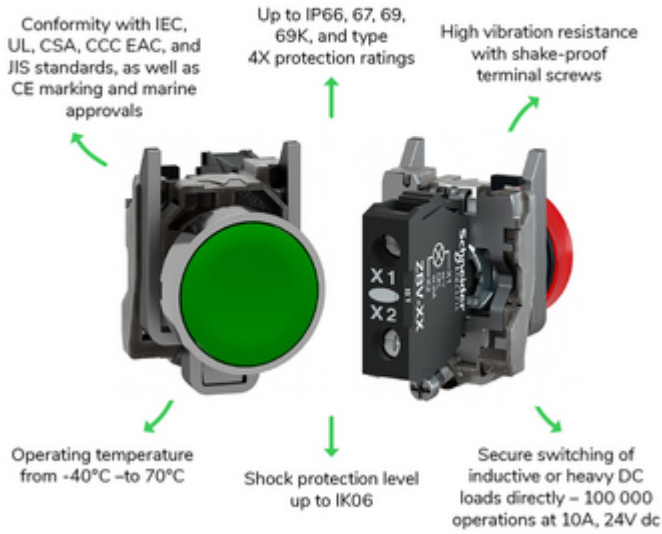

Offer Marketing Illustration

Product benefits / Features

---

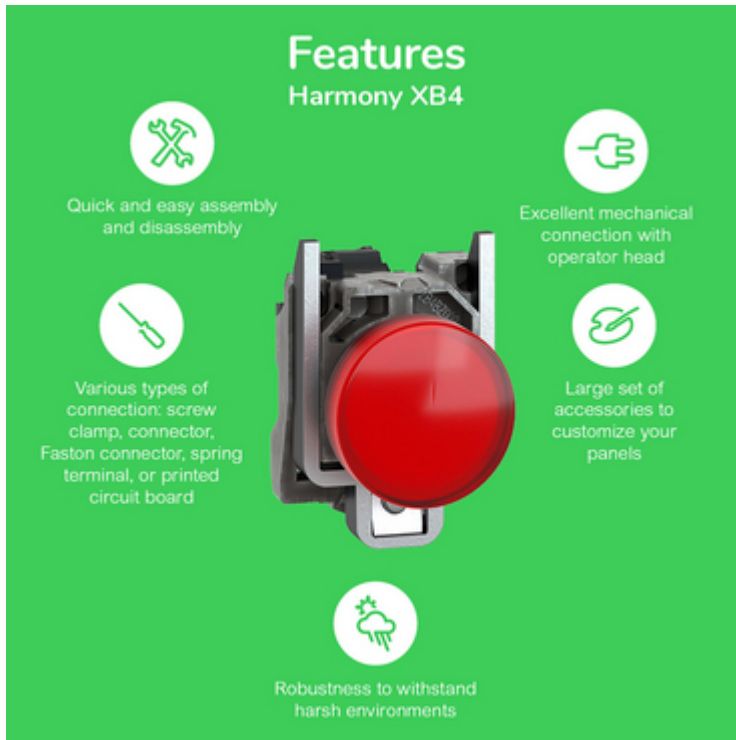

The infographic features a central image of a red Schneider XB4 terminal block against a green background. Surrounding the central image are five circular icons, each with a corresponding text description of a product feature. The features are: quick assembly, excellent mechanical connection, various connection types, a large set of accessories, and robustness for harsh environments.

### Features Harmony XB4





-  Quick and easy assembly and disassembly
-  Excellent mechanical connection with operator head
-  Various types of connection: screw clamp, connector, Faston connector, spring terminal, or printed circuit board
-  Large set of accessories to customize your panels
-  Robustness to withstand harsh environments

Image of product / Alternate images

Alternative

---





