



LV HRC fuse element, NH2, In: 300 A, gG, Un AC: 400 V, Combined indicator, insulated Grip lugs

Figure similar

| Model   |                                     |
|---|-------------------------------------|
| product brand name  | SETRON                              |
| product designation   | LV HRC fuse link                    |
| design of the product   | With blade contacts                 |
| design of an identification indicator   | Combination alarms                  |
| design of the switching contact   | Non-corroding, silver-plated        |
| design of the fuse link   | LV HRC fuse link                    |
| General technical data  |                                     |
| size of fuse system according to EN 60269-1   | NH2                                 |
| operating class of the fuse link  | gG                                  |
| mounting type   | insulated grip lugs                 |
| type of voltage of the operating voltage  | AC                                  |
| operational current at AC rated value   | 300 A                               |
| supply voltage  | 400 V                               |
| • at AC   |                                     |
| Protection class  |                                     |
| protection class IP   | IP20, with connected conductors     |
| Breaking Capacity   |                                     |
| breaking capacity at AC according to IEC 60269 rated value                          | 120 kA                              |
| Dissipation   |                                     |
| power loss [W]  | 23 W                                |
| power loss [W] for rated value of the current at AC in hot operating state per pole | 23 W                                |
| Mechanical Design   |                                     |
| width of the enclosure  | 57.8 mm                             |
| mounting position   | Any, preferably vertical            |
| Net Weight  | 659 g                               |
| Environmental conditions  |                                     |
| ambient temperature during operation  |                                     |
| • minimum   | -5 °C                               |
| • maximum   | 40 °C                               |
| environmental category  | -20 to +50 at 95% relative humidity |
| environmental category during storage   | 90% at 20°C                         |
| Certificates  |                                     |
| reference code according to IEC 81346-2   | FC                                  |
| Approvals Certificates  |                                     |
| Environment   | General Product Approval            |

[Environmental Con-  
firmations](#)

[Environmental Con-  
firmations](#)



[Miscellaneous](#)



|                               |     |                      |
|-------------------------------|-----|----------------------|
| General Product Ap-<br>proval | EMV | Maritime application |
|-------------------------------|-----|----------------------|



|                      |       |
|----------------------|-------|
| Maritime application | other |
|----------------------|-------|



[CCS \(China Classifica-  
tion Society\)](#)

[Miscellaneous](#)

#### Further information

Information on the packaging

<https://support.industry.siemens.com/cs/ww/en/view/109813875>

Information for data generation and storage

<https://support.industry.siemens.com/cs/ww/en/view/109995012>

Information- and Downloadcenter (Catalogs, Brochures,...)

<https://www.siemens.com/lowvoltage/catalogs>

Industry Mall (Online ordering system)

<https://mall.industry.siemens.com/mall/en/en/Catalog/product?mlfb=3NA6250-4>

Service&Support (Manuals, Certificates, Characteristics, FAQs,...)

<https://support.industry.siemens.com/cs/ww/en/ps/3NA6250-4>

Image database (product images, 2D dimension drawings, 3D models, device circuit diagrams, ...)

[https://www.automation.siemens.com/bilddb/cax\\_en.aspx?mlfb=3NA6250-4](https://www.automation.siemens.com/bilddb/cax_en.aspx?mlfb=3NA6250-4)

CAX-Online-Generator

<https://www.siemens.com/cax>

Tender specifications

<https://www.siemens.com/specifications>

Characteristic curves

[https://curves.simaris.siemens.com/curves/<mmp\\_prod\\_noCOMP="HAUPT"></mmp\\_prod\\_no>](https://curves.simaris.siemens.com/curves/<mmp_prod_noCOMP=)

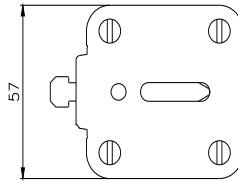
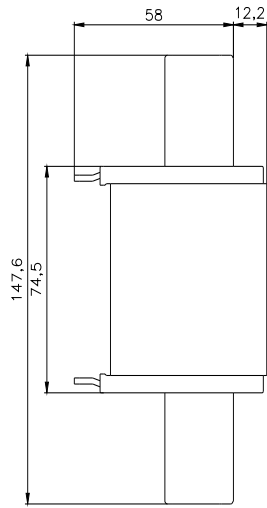

**-F**



# FU



---

last modified:

4/15/2025 

