



grounding screw for holder 3-fold, universal for plastic and metal (3SU1500-0AA10-0AA0), holder 3-fold, metal grounding of metal actuators for installation in front plates made of non-conductive materials



product brand name	SIRIUS ACT	
product designation	Grounding stud	
product type designation	3SU1	
<b>General technical data</b>		
Substance Prohibittance (Date)	07/01/2006	
Net Weight	1 g	
<b>Connections/ Terminals</b>		
tightening torque	0.8 ... 1 N·m	
<b>Ambient conditions</b>		
ambient temperature		
• during operation	-25 ... +70 °C	
• during storage and transport	-40 ... +80 °C	
<b>Accessories</b>		
material of accessory	Metal	
color of accessory	Silver	
<b>Approvals Certificates</b>		
Environmental Product Declaration		
• global warming potential [CO2 eq] / during manufacturing	0.625 kg	
• global warming potential [CO2 eq] / during operation	0.235 kg	
• global warming potential [CO2 eq] / after end of life	-0.267 kg	
• global warming potential [CO2 eq] / total	0.593 kg	
Environment	General Product Approval	Maritime application

[Environmental Confirmations](#)



Maritime application	other
----------------------	-------



[Confirmation](#)

**Further information**

Information on the packaging

<https://support.industry.siemens.com/cs/ww/en/view/109813875>

Information for data generation and storage

<https://support.industry.siemens.com/cs/ww/en/view/109995012>

Information- and Downloadcenter (Catalogs, Brochures,...)

<https://www.siemens.com/ic10>

Industry Mall (Online ordering system)

<https://mall.industry.siemens.com/mall/en/en/Catalog/product?mlfb=3SU1950-0KK80-0AA0>

Cax online generator

<https://support.automation.siemens.com/WW/CAXorder/default.aspx?lang=en&mlfb=3SU1950-0KK80-0AA0>

Service&Support (Manuals, Certificates, Characteristics, FAQs,...)

<https://support.industry.siemens.com/cs/ww/en/ps/3SU1950-0KK80-0AA0>

Image database (product images, 2D dimension drawings, 3D models, device circuit diagrams, EPLAN macros, ...)

[https://www.automation.siemens.com/bilddb/cax\\_de.aspx?mlfb=3SU1950-0KK80-0AA0&lang=en](https://www.automation.siemens.com/bilddb/cax_de.aspx?mlfb=3SU1950-0KK80-0AA0&lang=en)

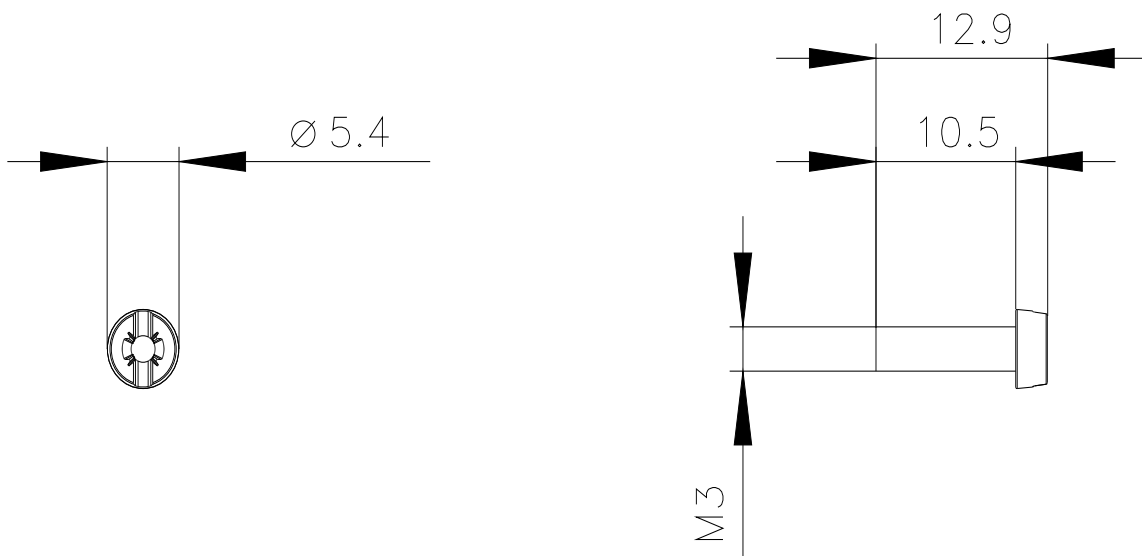

last modified:

4/2/2025 